



Smart Meeting Anesthesia  
Resuscitation inTensive care

**Milan | May 24-26, 2023**  
Allianz MiCo - South Wing



**PROGRAM**

ENDORSED BY



#### SMART - ORGANIZING AND SCIENTIFIC COMMITTEE

M. Antonelli, A. Braschi, L. Brazzi, L. Camporota, G. Citerio, G. Conti, L. Gattinoni, M. Girardis, A. Pesenti, M. Quintel, F. Raimondi, M. Senturk

#### SMART - SCIENTIFIC ADVISORY BOARD

H. Amirfarzan, P. Caironi, M. Cecconi, G. Cortese, A. De Gasperi, D. De Luca, T. Langer, A. Lucchini, J.J. Marini, P.M. Mertès, F. Mojoli, G. Paternoster, P. Pelosi, S. Romagnoli, G. Russo, F. Sangalli, S. Scolletta, G. Tavazzi

#### SMART - ORGANIZING SECRETARIAT

Start Promotion Srl  
Via Mauro Macchi, 50 - 20124 Milano - Italy  
Tel. +39 02 67071383 | Fax +39 02 67072294  
Email: [info@startpromotion.it](mailto:info@startpromotion.it) | [www.startpromotion.it](http://www.startpromotion.it)

# CONTENTS

---

Faculty .....	<b>6</b>
Program .....	<b>10</b>
Smart Nursing .....	<b>23</b>
WeSmart Sessions .....	<b>26</b>
Meet the Expert Sessions .....	<b>29</b>
Simulation Sessions .....	<b>32</b>
High Fidelity Simulation Sessions .....	<b>36</b>
Oral Presentations .....	<b>42</b>
E-Posters .....	<b>46</b>
Educational Courses .....	<b>54</b>
General Information .....	<b>62</b>
Exhibition .....	<b>68</b>
Acknowledgements .....	<b>70</b>
Layouts .....	<b>71</b>
Map of the Area .....	<b>74</b>

## FACULTY

## A

Agostini V., Genova (I)  
 Agostoni E., Milano (I)  
 Ajello V., Roma (I)  
 Allegri M., Morges (CH)  
 Amirfarzan H., Boston (USA)  
 Andreotti A., Modena (I)  
 Annane D., Paris (F)  
 Antonelli M., Roma (I)  
 Arnal J.M., Toulon (F)  
 Azoulay E., Paris (F)

## B

Baldini G., Firenze (I)  
 Ball L., Genova (I)  
 Bandera A., Milano (I)  
 Barbani F., Firenze (I)  
 Bartoletti M., Milano (I)  
 Behr A.U., Padova (I)  
 Bellani G., Trento (I)  
 Bělohávek J., Prague (CZ)  
 Berger M.M., Lausanne (CH)  
 Bertini P., Pisa (I)  
 Bignami E.G., Parma (I)  
 Bottari G., Roma (I)  
 Bouhemad B., Dijon (F)  
 Brazzi L., Torino (I)  
 Brochard L., Toronto (CDN)  
 Brusatori S., Goettingen (D)  
 Buetti N., Genève (CH)  
 Bugada D., Bergamo (I)  
 Busana M., Goettingen (D)  
 Busani S., Modena (I)  
 Bussolin L., Firenze (I)

## C

Cabrini L., Varese (I)  
 Caironi P., Torino (I)  
 Camporota L., London (UK)  
 Cantaluppi V., Novara (I)  
 Cappelleri G., Monza (I)  
 Capra C., Milano (I)  
 Caraceni P., Bologna (I)  
 Caricato A., Roma (I)  
 Cecconi M., Milano (I)  
 Chiumello D., Milano (I)  
 Citerio G., Monza (I)  
 Collino F., Torino (I)

Colombo D., Novara (I)  
 Combes A., Paris (F)  
 Constantin J.M., Clermont-Ferrand (F)  
 Conti G., Roma (I)  
 Conway Morris A., Cambridge (UK)  
 Corona A., Esine - Brescia (I)  
 Corradi F., Pisa (I)  
 Corso R.M., Forlì (I)  
 Cortegiani A., Palermo (I)  
 Cortese G., Torino (I)  
 Costa A., Novara (I)  
 Costamagna A., Torino (I)  
 Costantini E., Milano (I)

## D

Dall'Ara L., Modena (I)  
 Damiani E., Ancona (I)  
 De Cassai A., Padova (I)  
 De Ferrari G., Torino (I)  
 De Gasperi A., Milano (I)  
 De Luca D., Paris (F)  
 De Marchi L., Washington (USA)  
 De Pascale G., Roma (I)  
 De Robertis E., Perugia (I)  
 De Rosa S., Trento (I)  
 De Waele J., Ghent (B)  
 Di Masi A., Roma (I)  
 Di Nardo M., Roma (I)  
 Donadello K., Verona (I)  
 Donati A., Ancona (I)  
 Duska F., Prague (CZ)

## E

Etminan N., Mannheim (D)

## F

Falcetta S., Ancona (I)  
 Fanelli V., Torino (I)  
 Ferrer Roca R., Barcelona (E)  
 Fiorentino M., Bari (I)  
 Fiorindi C., Firenze (I)  
 Forfori F., Pisa (I)  
 Foti G., Monza (I)  
 Frassanito L., Roma (I)  
 Fumagalli J., Milano (I)  
 Fumagalli R., Milano (I)

## G

Gattarello S., Goettingen (D)  
 Gattinoni L., Goettingen (D)  
 Giannella M., Bologna (I)  
 Giannini A., Milano (I)  
 Giarratano A., Palermo (I)  
 Giosa L., London (UK)  
 Girardis M., Modena (I)  
 Gouel A., Paris (F)  
 Grasselli G., Milano (I)  
 Grasso S., Bari (I)  
 Grieco D.L., Roma (I)  
 Guarracino F., Pisa (I)

## H

Habre W., Genève (CH)  
 Helbok R., Innsbruck (A)  
 Hernandez Poblete G.W., Santiago (CL)  
 Heunks L., Rotterdam (NL)  
 Hilty M., Zurich (CH)

## I

Ichai C., Nice (F)  
 Ince C., Rotterdam (NL)  
 Iotti G.A., Pavia (I)

## J

Jaber S., Montpellier (F)  
 Joannidis M., Innsbruck (A)  
 Juffermans N., Amsterdam (NL)

## L

Laffey J., Galway (IRL)  
 Lamhaut L., Paris (F)  
 Landoni G., Milano (I)  
 Langer T., Milano (I)  
 Leissner K., Boston (USA)  
 Leo M., Alessandria (I)  
 Leone M., Marseille (F)  
 Ljungqvist O., Örebro (S)  
 Locatelli A., Pavia (I)  
 Lorini F.L., Bergamo (I)  
 Lorusso R., Maastricht (NL)

## M

Maggiore S.M., Chieti-Pescara (I)  
 Mancino A., Roma (I)  
 Marini J.J., St. Paul (USA)  
 Martin Loeches I., Dublin (IRL)  
 McAuley D., Belfast (UK)  
 Meissner K., Goettingen (D)  
 Memoli C., Roma (I)  
 Mertès P.M., Strasbourg (F)  
 Messina A., Milano (I)  
 Meyfroidt G., Leuven (B)  
 Michard F., Lausanne (CH)  
 Michelagnoli G., Firenze (I)  
 Moerer O., Goettingen (D)  
 Mojoli F., Pavia (I)  
 Mondino M.G., Milano (I)  
 Monge Garcia M.I., Jerez de la Frontera (E)  
 Mongodi S., Pavia (I)  
 Montrucchio G., Torino (I)  
 Monzani R., Milano (I)  
 Morelli A., Roma (I)  
 Moscatelli A., Genova (I)  
 Mossetti V., Torino (I)  
 Munari M., Padova (I)

## N

Naeije R., Bruxelles (B)  
 Najafi N., Bruxelles (B)  
 Nava S., Bologna (I)  
 Navalesi P., Padova (I)  
 Negro A., Milano (I)  
 Nielsen N., Albuquerque (USA)  
 Nierhaus A., Hamburg (D)

## O

Oddo M., Lausanne (CH)  
 Olivieri E., Verona (I)  
 Orlando A., Pavia (I)

## P

Panigada M., Milano (I)  
 Pasero D., Sassari (I)  
 Paternoster G., Potenza (I)  
 Pea F., Bologna (I)  
 Pedoto A., New York (USA)  
 Pelosi P., Genova (I)  
 Pesenti A., Milano (I)  
 Piastra M., Roma (I)  
 Pinelli F., Firenze (I)  
 Piquilloud L., Lausanne (CH)  
 Pirri C., Padova (I)  
 Povia P., Lisbon (P)  
 Protti A., Milano (I)

## Q

Quintel M., Deggendorf (D)

## R

Racca F., Alessandria (I)  
 Rachedi N., Roma (I)  
 Raimondi F., Pavia (I)  
 Raimondi M., Voghera (I)  
 Ranieri V.M., Bologna (I)  
 Rasulo F., Brescia (I)  
 Rauseo M., Foggia (I)  
 Rezoagli E., Monza (I)  
 Robba C., Genova (I)  
 Rocco P., Rio de Janeiro (BR)  
 Romagnoli S., Firenze (I)  
 Roncon-Albuquerque R., Oporto (P)  
 Rosboch G.L., Torino (I)  
 Rossi M., Roma (I)  
 Rossolini G., Firenze  
 Rubino A., Cambridge (UK)  
 Rubulotta F., Montreal (CDN)  
 Russo G., Lodi (I)  
 Russotto V., Torino (I)

## S

Sales G., Torino (I)  
 Sangalli F., Sondrio (I)

Sartelli M., Macerata (I)  
 Sbaraglia F., Roma (I)  
 Scaramuzzo G., Ferrara (I)  
 Scolletta S., Siena (I)  
 Senturk M., Istanbul (TR)  
 Sepolvere G., Caserta (I)  
 Silvetti S., Genova (I)  
 Siniscalchi A., Bologna (I)  
 Slutsky A., Toronto (CDN)  
 Sonnevile R., Paris (F)  
 Sorbello M., Ragusa (I)  
 Spinazza G., Varese (I)  
 Stocchetti N., Milano (I)

## T

Taccone F.S., Bruxelles (B)  
 Tascini C., Udine (I)  
 Tavazzi G., Pavia (I)  
 Teboul J.L., Le Kremlin-Bicêtre (F)  
 Tognù A., Bologna (I)  
 Torrano V., Milano (I)  
 Tritapepe L., Roma (I)  
 Tufano R., Napoli (I)

## V

Van den Berghe G., Leuven (B)  
 Vandenberghe C., Leuven (B)  
 Vaschetto R., Novara (I)  
 Via G., Lugano (CH)  
 Viale P., Bologna (I)  
 Vieillard-Baron A., Paris (F)  
 Vincent J.L., Bruxelles (B)  
 Volta C.A., Ferrara (I)

## W

Wiedermann C.J., Hall in Tirol (A)  
 Wolfler A., Genova (I)  
 Wouters P.F., Ghent (B)

## Z

Zanella A., Milano (I)  
 Zanier E., Milano (I)

Dear colleague,

On behalf of the Organising Committee, we would like to thank you for attending the 2023 edition of the SMART meeting, and we look forward to seeing you in Milan.

This year the SMART meeting will be full of relevant and up-to-date educational and scientific content delivered live using a variety of formats. Each session has been carefully designed and thought through with your needs in mind. We wanted to maximise the space for debate, round tables, and interactive sessions to give you the opportunity to share your experience with colleagues around the world and members of the faculty, and actively contribute to discussions and debates.

To make the most of your time at the SMART meeting – please take some time to read through the format of each session so that you can take full advantage of the content and opportunity for participation.

We really hope you will find SMART meeting educational, inspiring and fun. See you in Milan!

### Classical Sessions

These sessions are 'high level review' of a specific topic. They reflect the current literature and contain 2-3 general take-home messages for education and discussion. The sessions reflect wider knowledge and their content is meant to be clinically-oriented and educational. There is a 15 min slot for general discussion at the end of each session.

### Let's discuss about

This is a new and special session where the evidence on a topic is summarised by the 'presenter' using slides and a group of 'dissectors' will discuss and 'dissect' the topic in a roundtable-style fashion facilitated by a chairperson. Attendants involvement is encouraged.

### Round Tables

These sessions are designed to discuss a topic with unclear evidence which admits more than one point of view. The round tables reflect these differences using data in the literature, personal experience or beliefs. The chairperson will ensure that the discussion will have high quality content and that time is used effectively and that each discussant has equal opportunity to present ideas and concepts.

### Tutorials

These sessions will present the concepts of applied physiology at more basic level and are aimed at the younger audience. The emphasis here is educational value of the physiological fundamentals of critical care.

### Pro-Con

These sessions are arranged as pro con debates. Each presenter will state their case pro or against a topic and there will be time for a short rebuttal and discussion.

### Discussion with Ballot

These sessions are designed to explore the pros, the cons and the doubts around a specific topic, clinical case or clinical intervention. These sessions are interactive. The speaker will present 4 multiple choice questions each with 3 possible options. Single best option will be accepted. You will be invited to participate using a voting/polling system.

### Friday-Night & Monday Morning

These are very practical sessions meant to present how the speaker would go about addressing a specific clinical issue on an hypothetical 'Friday night admission and Monday morning clinical round with the ICU chief'. Emphasis is given to cases and practical advice, including what to 'watch out'.

# PROGRAM

The session series entitled **Antonio Braschi's Tutorials for Lifelong Learning** are educational sessions on the fundamentals of physiology and critical care. They are intended to be a tribute to Antonio Braschi, mainstay of our SMART meeting, reflecting his passion for education in our discipline.

Learning from individuals who are passionate about their work and committed to sharing their knowledge is a powerful source of inspiration for all generations and is the indelible gift and inheritance that Antonio Braschi has left us.

**AMBER HALL 1-2**

9.30 - 10.30  
**LET'S DISCUSS ABOUT LUNG RECRUITMENT**  
Presenter: L. Piquilloud

DISSECTION  
Chairperson: L. Camporota  
Dissectors: L. Brochard, L. Gattinoni, J.J. Marini

10.30 - 11.00  
**AWARD LECTURE**  
Chairperson: L. Gattinoni

**My scientific journey through the ups and downs of sugar control**  
G. Van den Berghe

11.00 *Break and Exhibition Visit*

11.30 - 12.30  
**PRO-CON SHOULD WE BURY ADRENERGIC INOTROPES?**  
Chairperson: M.J. Monge Garcia

Pro: R. Fumagalli  
Con: G. Tavazzi

12.30 *Lunch Break*

**AMBER HALL 3-4**

**HOW TO MANAGE PERSISTING INFLAMMATION IN ICU**  
Chairpersons: M. Antonelli, N. Nielsen

9.30 **Evaluating and treating the immune system**  
M. Girardis

9.45 **The role of endothelium**  
N. Nielsen

10.00 **Colonization and secondary infections**  
I. Martin-Loeches

10.15 **Blood purification for organ support**  
S. De Rosa

10.30 **Source control**  
M. Sartelli

10.45 **Discussion**

11.00 *Break and Exhibition Visit*

11.30 - 12.30  
**LET'S DISCUSS ABOUT PERIOPERATIVE HEMODYNAMIC MONITORING**  
Presenter: A. Messina

DISSECTION  
Chairperson: F. Guarracino  
Dissectors: K. Donadello, F. Michard, J.L. Teboul

12.30 *Lunch Break*

**AMBER HALL 5-6**

**VENTILATOR INDUCED LUNG INJURY**  
Chairpersons: P. Pelosi, A. Slutsky

9.30 **How to minimize ventilator induced lung injury?**  
P. Rocco

9.45 **Ventilation Induced Diaphragm Dysfunction (VIDD) in 2023**  
S. Jaber

10.00 **Impact of mechanical ventilation on the diaphragm and respiratory muscles**  
L. Heunks

10.15 **Dead space ventilation as a mechanism of VILI**  
A. Pesenti

10.30 **Lung and hemodynamic interaction in the development of Ventilator Lung Injury**  
M. Busana

10.45 **Discussion**

11.00 *Break and Exhibition Visit*

11.30 - 12.30  
**PRO-CON MECHANICAL VENTILATION IN ARDS**  
*Supported by DRAEGER*  
Chairperson: M. Quintel

**Airway Pressure Release Ventilation (APRV)**  
Pro: L. Camporota  
Con: A. Pesenti

12.30 *Lunch Break*

**AMBER HALL 7**

**WHAT'S NEW IN PEDIATRIC ARDS**  
*In collaboration with SARNePI*  
Chairpersons: G. Conti, D. De Luca

10.00 **Neonatal ARDS: from the Montreux definition to its clinical application**  
D. De Luca

10.15 **Surfactant therapies for infants and children with ARDS: where is the evidence?**  
A. Wolfler

10.30 **ECMO in pediatric patients: focus on immunocompromised children**  
M. Di Nardo

10.45 **Discussion**

**SEPSIS LOOKING FORWARD**  
Chairpersons: M. Girardis, P. Povoia

11.00 **Sepsis 2 and Sepsis 3 in clinical practice**  
R. Ferrer Roca

11.15 **Artificial intelligence and new technologies for improving survival**  
E.G. Bignami

11.30 **How to de-escalate antimicrobials rapidly and safely**  
G. De Pascale

11.45 **Are we going towards Sepsis 4?**  
J.L. Vincent

12.00 **Optimizing resuscitation strategies**  
G.W. Hernandez Pobleto

12.15 **Discussion**

12.30 *Lunch Break*

**BROWN HALL 1**

**ANTONIO BRASCHI'S TUTORIALS FOR LIFELONG LEARNING**  
**BASIC PHYSIOLOGY 1**  
Presenter: G. Bellani

9.30 **Beside respiratory physiology**  
L. Heunks

10.00 **Beside cardiocirculatory physiology**  
R. Naeije

10.30 **Understanding a gas analysis: from numbers to the respiratory and cardiocirculatory status**  
L. Camporota

11.00 *Break and Exhibition Visit*

**ANTONIO BRASCHI'S TUTORIALS FOR LIFELONG LEARNING**  
**BASIC PHYSIOLOGY 2**  
Presenter: T. Langer

11.30 **Understanding acid-base balance**  
T. Langer

12.00 **CO<sub>2</sub> dead space and capnography: what is good to know**  
F. Collino

12.30 *Lunch Break*

**BROWN HALL 2**

**ANTONIO BRASCHI'S TUTORIALS FOR LIFELONG LEARNING**  
**CARDIO CIRCULATORY 1**  
Presenter: A. De Gasperi

9.30 **Cardiocirculatory drugs in the critically ill**  
G. Landoni

10.00 **Fluid management**  
J.L. Teboul

10.30 **Diagnosis and treatment of RV failure**  
R. Naeije

11.00 *Break and Exhibition Visit*

**FRIDAY NIGHT ADMISSION & MONDAY MORNING CLINICAL ROUND (WITH THE ICU CHIEF!)**  
Chairperson: G. Foti

11.30 **PATIENT WITH LEUKEMIA AND HYPOXEMIC RESPIRATORY FAILURE**  
Friday night admission  
D.L. Grieco  
Monday morning round with E. Azoulay (*remote connection*)

12.00 **PATIENT WITH COVID-19 ARDS**  
Friday night admission  
V. Rusotto  
Monday morning round with G. Bellani

12.30 *Lunch Break*

### AMBER HALL 1-2

12.45 - 14.15  
**LUNCH SESSION**  
**ADVANCED BLOOD PURIFICATION THERAPIES IN ENDOTOXIN-INDUCED SHOCK AND SEPTIC-AKI**  
*Supported by ESTOR*  
Chairpersons: R. Ferrer Roca, M. Girardis

From endotoxemia to endotoxin-induced shock: the dysregulated host response  
M. Girardis

Endotoxin cross-talk in the critically ill: from gut-dysbiosis to superinfections  
R. Ferrer Roca

The golden hour of Polymyxin B hemoperfusion: experts' recommendations  
S. De Rosa

New frontiers in septic-AKI: pathophysiology, clinical management and role of dialysis membrane  
M. Fiorentino

Discussion

---

**CARDIOGENIC SHOCK**  
Chairpersons: F. Sangalli, C. Vandenbriele

14.30 Pathophysiology: ischemic vs. non-ischemic  
G. De Ferrari

14.45 Pharmacological strategies  
A. Morelli

15.00 Mechanical support  
C. Vandenbriele

15.15 Are we aiming at the right targets?  
G. Tavazzi

15.30 Discussion

16.00 Break

*Antonio Braschi still with us. Get together in the Exhibition Area.*

---

**HOW TO TREAT CRITICALLY ILL PATIENTS WITH GRAM-NEGATIVE MDR: FROM GUIDELINES TO CLINICAL PRACTICE**  
Chairpersons: A. Cortegiani, G. Grasselli

16.30 Indications from guidelines  
I. Martin-Loeches

16.45 Role of fast microbiology  
A. Bandera

17.00 Infection control and AMS: win-win strategy  
M. Bartoletti

17.15 Translating to clinical practice  
J. De Waele

17.30 Discussion

### AMBER HALL 3-4

**EVIDENCE-BASED MEDICINE IN SEPSIS: ARE WE MAKING PROGRESS?**  
Chairpersons: I. Martin Loeches, A. Pesenti

14.30 Patient-based approach for the management of sepsis  
J.L. Vincent

14.45 Evidence-based approach to the management of sepsis  
V.M. Ranieri

15.00 Intermediate targets are important  
L. Gattinoni

15.15 Biomarkers: are they useful?  
P. Caironi

15.30 Extracorporeal therapies: where are we?  
C. Ince

15.45 Discussion

16.00 Break

*Antonio Braschi still with us. Get together in the Exhibition Area.*

---

**VASOPRESSORS AND INOTROPES IN HYPOTENSIVE STATE**  
Chairpersons: M. Cecconi, R. Fumagalli

16.30 My goals when I use vasoactive drugs  
J.L. Teboul

16.45 Early vasopressors: yes, but...  
A. Vieillard-Baron

17.00 Different drugs or different strategies in vasopressor use  
M.I. Monge Garcia

17.15 Inotropes: combination strategy or single agent?  
F. Guarracino

17.30 Discussion

### AMBER HALL 5-6

12.45 - 14.15  
**LUNCH SESSION**  
**ALBUMIN ADMINISTRATION IN CRITICALLY ILL PATIENTS: WHAT'S NEW**  
*Supported by CSL BEHRING, GRIFOLS*  
Chairpersons: P. Caironi, L. Gattinoni

Albumin administration as a colloid in the critically ill: a clinical overview  
C.J. Wiedermann

Detoxifying capacity of human albumin: from *in vitro* studies to humans  
A. Di Masi

Long-term effect of albumin treatment in cirrhosis  
P. Caraceni

Efficacy of albumin in critically ill patients: a long journey  
J.L. Vincent

Discussion

---

**PHARMACOLOGICAL THERAPY IN ARDS**  
Chairpersons: D. Annane, P. Rocco

14.30 Stem cells  
J. Laffey

14.45 Steroids  
M. Antonelli

15.00 Do pharmacological therapy have any future for ARDS?  
P. Rocco

15.15 Surfactant in adult ARDS  
S. Busani

15.30 Discussion

16.00 Break

*Antonio Braschi still with us. Get together in the Exhibition Area.*

---

**RECRUITMENT: WHAT ARE WE MEASURING?**  
Chairpersons: L. Gattinoni, M. Quintel

16.30 Quantitative CT scan  
D. Chiumello

16.45 Lung morphology  
J.M. Constantin

17.00 Pressure-volume curve  
L. Brochard

17.15 Tidal lung hysteresis  
F. Mojoli

17.30 Discussion

### AMBER HALL 7

**HOT TOPICS IN PEDIATRIC ANESTHESIA**  
*In collaboration with SARNePI*  
Chairpersons: W. Habre, A. Mancino

14.30 Fascial blocks, central blocks: new indications, new perspectives  
V. Mossetti

14.45 Safety in Non Operating Room Anesthesia  
N. Najafi

15.00 Intraoperative ventilation in pediatric patients  
W. Habre

15.15 It's time to explore lateral position  
F. Sbaraglia

15.30 Discussion

16.00 Break

*Antonio Braschi still with us. Get together in the Exhibition Area.*

---

**FOCUS ON PEDIATRIC TRAUMA**  
*In collaboration with SARNePI*  
Chairpersons: L. Bussolin, G. Conti

16.30 How to organize a Pediatric Trauma Center  
L. Bussolin

16.45 Head trauma management in children  
A. Mancino

17.00 Spinal trauma in the pediatric patient  
A. Moscatelli

17.15 Thoracic trauma in children  
M. Piastra

17.30 Discussion

### AMBER HALL 8

16.30 - 18.00  
Riunione Gruppo di Studio  
**ALBIOSS-BALANCED**

### BROWN HALL 1

**ANTONIO BRASCHI'S TUTORIALS FOR LIFELONG LEARNING**  
**THE VENTILATOR 1**  
Presenter: S. Grasso

14.30 Setting and monitoring the ventilation for the difficult-to-ventilate patient  
S. Grasso

15.00 How to improve patient-ventilator synchrony  
A. Orlando

15.30 Weaning from mechanical ventilation  
L. Heunks

16.00 Break

*Antonio Braschi still with us. Get together in the Exhibition Area.*

---

**ANTONIO BRASCHI'S TUTORIALS FOR LIFELONG LEARNING**  
**RENAL FUNCTION**  
Presenter: S. De Rosa

16.30 Renal physiology and mechanisms of AKI  
M. Joannidis

17.00 Management of oliguria  
V. Cantaluppi

17.30 CRRT  
S. De Rosa

### BROWN HALL 2

**ANTONIO BRASCHI'S TUTORIALS FOR LIFELONG LEARNING**  
**CARDIO CIRCULATION 2**  
Presenter: S. Scolletta

14.30 Echo-monitoring of the cardiac function and hemodynamics  
G. Tavazzi

15.00 Cardiogenic shock and mechanical supports  
A. Costamagna

15.30 Cardiac output measurement techniques  
S. Scolletta

16.00 Break

*Antonio Braschi still with us. Get together in the Exhibition Area.*

---

**ANTONIO BRASCHI'S TUTORIALS FOR LIFELONG LEARNING**  
**MISCELLANEA 1**  
Presenter: L. Brazzi

16.30 Allergic reactions in anesthesia  
P.M. Mertès

17.00 The hematologic patient in ICU  
G. Sales

17.30 Strategies to prevent central line-associated bloodstream infections in ICU  
N. Buetti

## AMBER HALL 1-2

**HEMODYNAMIC INSTABILITY***In collaboration with ITACTA*

Chairpersons: V. Ajello, F. Guarracino

- 9.00 **A pathophysiological approach**  
P. Wouters
- 9.15 **When the problem is hypertension**  
G. Paternoster
- 9.30 **When the problem is hypotension**  
K. Donadello
- 9.45 **When the problem is rhythm**  
A. Morelli
- 10.00 **The added value of neuromonitoring**  
S. Romagnoli
- 10.15 **Basic hemodynamic monitoring**  
S. Scotletta
- 10.30 **Discussion**
- 11.00 *Break and Exhibition Visit*

**LOCOREGIONAL ANESTHESIA AND HEMODYNAMIC IMPLICATIONS***In collaboration with ITACTA*

Chairpersons: G. Sepolvere, S. Silveti

- 11.30 **Fascial plane block in cardiac surgery: a future to discover**  
K. Leissner
- 11.45 **Neuraxial and fascial plane blocks: two sides of the same coins?**  
A. Tognù
- 12.00 **Superficial and deep parasternal block in cardiac surgery: different twins**  
G. Sepolvere
- 12.15 **Postoperative efficacy of loco-regional anesthesia in cardiac surgery**  
P. Bertini
- 12.30 *Lunch Break*

## AMBER HALL 3-4

9.00 - 10.00  
**LET'S DISCUSS ABOUT FLUIDS**

Presenter: A. Messina

## DISSECTION

Chairperson: P. Caironi

Dissectors: L. Camporota, G.W. Hernandez Poblete, A. Vieillard-Baron

## 10.00 - 11.00

**LET'S DISCUSS ABOUT INVASIVE / NONINVASIVE VENTILATION**

Presenter: D.L. Grieco

## DISSECTION

Chairperson: G. Foti

Dissectors: G. Grasselli, S.M. Maggiore, V.M. Ranieri

11.00 *Break and Exhibition Visit*

## 11.30 - 12.30

**LET'S DISCUSS ABOUT BLOOD PURIFICATION IN SEPSIS**

Presenter: S. De Rosa

## DISSECTION

Chairperson: M. Girardis

Dissectors: G. Bottari, R. Ferrer Roca, S. Romagnoli

12.30 *Lunch Break*

## AMBER HALL 5-6

**WEANING FROM MECHANICAL VENTILATION: PATIENT ASSESSMENT**

Chairpersons: G. Bellani, L. Heunks

- 9.00 **What's new in diaphragm assessment**  
S. Jaber
- 9.15 **Automation of the weaning process**  
J.M. Arnal
- 9.30 **Ultrasound approach to weaning**  
B. Bouhemad

**WEANING FROM MECHANICAL VENTILATION: CLINICAL PRACTICE**

Chairpersons: G. Bellani, L. Heunks

- 9.45 **Preventing extubation failure with noninvasive support**  
R. Vaschetto
- 10.00 **Results of the WEAN SAFE study**  
J. Laffey
- 10.15 **Weaning patients in ICU according their pathology: a new paradigm!**  
S. Jaber
- 10.30 **Discussion**

11.00 *Break and Exhibition Visit***USE OF NASAL HIGH FLOW IN CLINICAL PRACTICE: WHAT'S NEW?***Supported by Fisher & Paykel Healthcare*

Chairpersons: M. Antonelli, G. Grasselli

- 11.30 **Use of NHF to prevent post-extubation failure**  
S.M. Maggiore
- 11.45 **New interface design: physiological and clinical effects**  
P. Navalesi
- 12.00 **Use of NHF in Emergency: a way to prevent escalation of treatment?**  
V.M. Ranieri
- 12.15 **Discussion**
- 12.30 *Lunch Break*

## AMBER HALL 7

**FIRST HOUR OF SEPSIS MANAGEMENT IN 2023**

Chairpersons: J. De Waele, A. Nierhaus

- 9.00 **Early vasopressor**  
G. Grasselli
- 9.15 **How to identify infection and sepsis**  
M. Leone
- 9.30 **Source control: quick but not aggressive**  
J. De Waele
- 9.45 **Empiric antibiotics in difficult microorganisms**  
M. Giannella
- 10.00 **Fluid target: less is more?**  
M. Ceconi
- 10.15 **Discussion**
- 11.00 *Break and Exhibition Visit*

**ANESTHESIA AND CO-EXISTING DISEASES**

Chairpersons: A. Giarratano, V. Torrano

- 11.30 **Anesthesia in patients with anticoagulant treatment**  
G. Landoni
- 11.45 **Anesthesia in patients with chronic heart failure**  
F. Sangalli
- 12.00 **Postoperative care of the obese patient**  
J. Fumagalli
- 12.15 **Anesthesia in patients with neuromuscular disorders**  
F. Racca
- 12.30 **Anesthesia in patients with respiratory obstructive disease**  
C.A. Volta
- 12.45 **Discussion**
- 13.00 *Lunch Break*

## AMBER HALL 8

**ALLERGY REACTIONS IN ANESTHESIA**

Chairpersons: H. Amirfarzan, K. Leissner

- 9.00 **Epidemiology of perioperative anaphylaxis**  
E. Olivieri
- 9.15 **How to treat an anaphylactic shock: the present and the future?**  
A. Gouel
- 9.30 **Can we reduce the allergy risk to NMBAs?**  
P.M. Mertès
- 9.45 **Discussion**

## 10.00 - 11.00

**ROUND TABLE THE GENDER PROBLEM IN CRITICAL CARE**

L. Brazzi, P. Pesenti, C. Robba, F. Rubulotta, R. Tufano

11.00 *Break and Exhibition Visit***OPERATING ROOM AIRWAY MANAGEMENT IN 2023: WELCOME TO THE JUNGLE***In collaboration with EAMS*

Chairpersons: L. Brazzi, M. Senturk

- 11.30 **How are the guidelines changing?**  
M. Sorbello
- 11.45 **Is there still a role for the classic laryngoscope?**  
G. Cortese
- 12.00 **The role of human factor**  
S. Falcetta
- 12.15 **Discussion with ballot**
- 12.30 *Lunch Break*

## BROWN HALL 1

**ANTONIO BRASCHI'S TUTORIALS FOR LIFELONG LEARNING****THE VENTILATOR 2**

Presenter: F. Mojoli

- 9.00 **Measuring oesophageal and driving pressure**  
L. Brochard
- 9.30 **High Flow Nasal Cannula: indications and techniques**  
S.M. Maggiore
- 10.00 **Ventilation management in thoracic surgery**  
A. Pedoto
- 10.30 **Lung mechanics to set PEEP**  
F. Mojoli
- 11.00 *Break and Exhibition Visit*

**ANTONIO BRASCHI'S TUTORIALS FOR LIFELONG LEARNING****COMMON PROBLEMS IN ICU 1**

Presenter: A. Zanella

- 11.30 **Patient blood management in intensive care**  
P.M. Mertès
- 12.00 **Managing the organ donor patient**  
A. Zanella
- 12.30 *Lunch Break*

## BROWN HALL 2

**ANTONIO BRASCHI'S TUTORIALS FOR LIFELONG LEARNING****INFECTIONS 1**

Presenter: G. Montrucchio

- 9.00 **Sepsis: pathophysiology and how to suspect**  
M. Antonelli
- 9.30 **Clinical approach to antibiogram**  
G. Montrucchio
- 10.00 **Managing sepsis and septic shock**  
S. Busani
- 10.30 **Optimal use of antibiotics in the critically ill**  
P. Viale
- 11.00 *Break and Exhibition Visit*

**FRIDAY NIGHT ADMISSION & MONDAY MORNING CLINICAL ROUND (WITH THE ICU CHIEF!)**

Chairperson: C.A. Volta

- 11.30 **PATIENT WITH COPD EXACERBATION**  
Friday night admission  
M. Raucio  
Monday morning round with  
L. Brochard
- 12.00 **PATIENT WITH ABDOMINAL SEPTIC SHOCK**  
Friday night admission  
A. Cortegiani  
Monday morning round with  
J. De Waele
- 12.30 *Lunch Break*



**AMBER HALL 1-2**

13.00 - 14.00  
**LUNCH SESSION**  
**PERIOPERATIVE HYPERTENSION IN CRITICALLY ILL PATIENTS: A PATHOPHYSIOLOGICAL APPROACH**  
*Supported by CHIESI ITALIA*  
Chairpersons: A. Locatelli, L. Tritapepe

Pathophysiology of hypertension in critically ill patients  
G. Paternoster

Pharmacological strategies in critically ill patients with hypertension  
F.L. Lorini

Hemodynamic monitoring in critically ill patients with hypertension  
M.G. Mondino

Discussion

**POSTOPERATIVE COGNITIVE DYSFUNCTION (POCD) FOLLOWING CARDIAC SURGERY**  
*In collaboration with ITACTA*  
Chairperson: S. Scolletta

14.30 Complex scenario presentation  
V. Ajello

14.45 **PRO-CON. Optimizing patient monitoring to preserve the brain during cardiac surgery**  
- Value of EEG  
- Role of NIRS monitoring  
- Optimum blood pressure during bypass  
H. Amirfarzan, K. Leissner

15.45 Discussion

16.00 *Break and Exhibition Visit*

**HOT TOPICS IN PERIOPERATIVE ECHOCARDIOGRAPHY**  
*In collaboration with ITACTA*  
Chairpersons: V. Ajello, F. Sangalli

16.30 **TEE to guide intraoperative decision making**  
A. Rubino

16.45 **What is myocardial strain and is it useful in the perioperative setting?**  
P.F. Wouters

17.00 **Basic and advanced TEE in the ICU**  
F. Guarracino

17.15 **TEE for liver transplantation**  
L. De Marchi

17.30 Discussion

**AMBER HALL 3-4**

**ENHANCED RECOVERY AFTER SURGERY: THE DEVIL IS IN THE DETAIL**  
Chairpersons: G. Baldini, M. Senturk

14.30 Perioperative medicine and ERAS: current challenges and future directions  
O. Ljungqvist

14.45 Prehabilitation: recovery begins before surgery  
G. Baldini

15.00 Intraoperative technology support to ERAS  
S. Romagnoli

15.15 Postoperative monitoring  
F. Michard

15.30 Discussion

16.00 *Break and Exhibition Visit*

**HOW TO IMPLEMENT AN ENHANCED RECOVERY AFTER SURGERY PROGRAM FOR MAJOR ABDOMINAL SURGERY: BARRIERS AND FACILITATORS**  
Chairpersons: H. Amirfarzan, S. Romagnoli

16.30 How to build a "Prehabilitation Center": from ideas to action  
G. Baldini

16.45 Surgeons have a key role  
O. Ljungqvist

17.00 Strategies to promote adherence to nutritional protocols in the ERAS program  
C. Fiorindi

17.15 Discussion

**AMBER HALL 5-6**

**ECMO FOR RESPIRATORY FAILURE**  
Chairpersons: A. Pesenti, M. Quintel

14.30 Are the times ripe for a more liberal use of ECMO in ARDS patients?  
A. Combes

14.45 Is extracorporeal CO<sub>2</sub> removal the future of ARDS management?  
A. Slutsky

15.00 Did ECMO improve survival in COVID-19 ARDS patients?  
L. Camporota

15.15 Early extubation in ECMO patients  
R. Roncon Albuquerque

15.30 Discussion

16.00 *Break and Exhibition Visit*

**WHICH PaO<sub>2</sub> TARGET IN MY PATIENT?**  
Chairpersons: A. Donati, A. Pesenti

16.30 Physiology and U relationship  
N. Juffermans

16.45 Brain and O<sub>2</sub>  
G. Citerio

17.00 Mild hypoxia in patients with respiratory dysfunction?  
D. McAuley

17.15 Perioperative oxygenation  
E. Damiani

17.30 Discussion

**AMBER HALL 7**

**DISCUSSION WITH BALLOT INFECTIONS AND SEPSIS IN SPECIFIC POPULATIONS**  
Chairpersons: G. Grasselli, P. Viale

14.30 Sepsis in immunosuppressed patients  
E. Azoulay (*remote connection*), P. Povo

15.00 Sepsis in surgical patient  
N. Nielsen, D. Pasero

15.30 Sepsis in end-stage liver disease  
A. Conway Morris, K. Donadello

16.00 *Break and Exhibition Visit*

**SEVERE COMMUNITY-ACQUIRED PNEUMONIA: FUNDAMENTAL ELEMENTS**  
Chairpersons: G. De Pascale, S.M. Maggiore

16.30 Slow and fast microbiological diagnosis  
A. Conway Morris

16.45 Antibiotics and antivirals  
P. Povo

17.00 Steroids: to whom and when  
D. Annane

17.15 How to approach worsening patients  
G. De Pascale

17.30 Role of respiratory support  
G. Grasselli

17.45 Discussion

**AMBER HALL 8**

12.45 - 14.15  
**LUNCH SESSION**  
**ROUND TABLE**  
**PERSONALIZED THERAPY WITH IgM IN CRITICALLY ILL PATIENTS WITH INFECTIONS**  
*Supported by BIOTEST*  
Chairpersons: M. Girardis, G. Montrucchio

Critical review of the international sepsis guidelines focusing on IgG/IgM as adjunctive therapies  
A. Nierhaus

IgM and meningitis  
C. Tascini

IgM and peritonitis  
A. Corona

IgM and pneumonias  
S. Busani

Discussion

**HOT TOPICS**  
Chairpersons: J.J. Marini, V.M. Ranieri

14.30 ECMO versus ECCO<sub>2</sub>R in lung injury: is oxygenation really different?  
L. Gattinoni

14.45 PEEP selection: personalized or not?  
O. Moerer

15.00 Morphine versus hydromorphone in pain control  
K. Meissner

15.15 How to recognize patients with strong inspiratory efforts without any advanced monitoring?  
A. Protti

15.30 Ventriculo-arterial coupling in septic shock  
M.I. Monge Garcia

15.45 Discussion

16.00 *Break and Exhibition Visit*

**ELECTROLYTE REPLACEMENTS**  
Chairpersons: F. Duska, A. Zanella

16.30 The neglected electrolytes: calcium and magnesium  
F. Duska

16.45 The chloride: what for?  
L. Gattinoni

17.00 Saline, ringer and balanced solutions: when is the choice mandatory?  
P. Caironi

17.15 Mechanical ventilation and fluid-electrolyte imbalance  
S. Gattarello

17.30 Discussion

**BROWN HALL 1**

**ANTONIO BRASCHI'S TUTORIALS FOR LIFELONG LEARNING**  
**NEUROLOGY 1**  
Presenter: M. Oddo

14.30 Diagnosis and management of delirium  
R. Sonnevile

15.00 Noninvasive monitoring of the brain function  
C. Robba

15.30 Management of brain injury  
G. Meyfroidt

16.00 *Break and Exhibition Visit*

**ANTONIO BRASCHI'S TUTORIALS FOR LIFELONG LEARNING**  
**NEUROLOGY 2**  
Presenter: M. Oddo

16.30 Post-resuscitation care of cardiac arrest  
F.S. Taccone

17.00 Pupillometry  
M. Oddo

17.30 Meningitis and encephalitis in ICU  
R. Sonnevile

**BROWN HALL 2**

**ANTONIO BRASCHI'S TUTORIALS FOR LIFELONG LEARNING**  
**INFECTIONS 2**  
Presenter: A. Donati

14.30 Organ crosstalk in sepsis  
A. Cortegiani

15.00 Source control  
M. Sartelli

15.30 From macro to micro circulation in sepsis  
A. Donati

16.00 *Break and Exhibition Visit*

**ANTONIO BRASCHI'S TUTORIALS FOR LIFELONG LEARNING**  
**NUTRITION AND FLUIDS**  
Presenter: T. Langer

16.30 Energy requirements  
M.M. Berger

17.00 Nutritional strategy in the critically ill  
C. Ichai

17.30 Fluids and electrolytes balance  
T. Langer

## AMBER HALL 1-2

**LUNG ULTRASOUND 2.0:  
THE QUANTITATIVE APPROACH**

Chairpersons: B. Bouhemad, F. Mojoli

9.00 **Switching from qualitative to quantitative Lung Ultrasound**  
S. Mongodi9.15 **In the adult ICU**  
B. Bouhemad9.30 **In the pediatric ICU**  
D. De Luca9.45 **To predict failure of noninvasive respiratory support**  
F. Mojoli10.00 **Any role for automation?**  
F. Corradi10.15 **Levels of competences and required training**  
S. Mongodi10.30 **Discussion**11.00 *Break and Exhibition Visit***ERECTOR SPINAE BLOCK:  
LIGHTS AND SHADOWS**

Chairpersons: A.U. Behr, V. Torrano

11.30 **Anatomical considerations: can we talk about ESP block as myofascial plane block?**  
C. Pirri11.45 **Description of the technique and clinical application: how and when should we do it**  
G. Russo12.00 **Plane blocks and local anesthetic toxicity**  
A. De Cassai12.15 **Discussion**12.30 *Lunch Break*

## AMBER HALL 3-4

9.00 - 10.00  
**LET'S DISCUSS ABOUT  
PEEP**

Presenter: F. Collino

DISSECTION  
Chairperson: L. Gattinoni

Dissectors: S. Jaber, J.J. Marini, A. Slutsky

10.00 - 11.00  
**LET'S DISCUSS ABOUT  
MECHANICAL CIRCULATORY SUPPORT  
IN CARIOGENIC SHOCK: AN EVOLVING  
STORY**

Presenter: C. Vandenbrielle

DISSECTION  
Chairperson: G. Tavazzi

Dissectors: J. Bělohávek, A. Combes, R. Lorusso

11.00 *Break and Exhibition Visit*11.30 - 12.30  
**LET'S DISCUSS ABOUT  
CONTINUOUS EEG MONITORING IN ICU**

Presenter: A. Caricato

DISSECTION  
Chairperson: R. Sonnevile

Dissectors: H. Amirfarzan, M. Oddo, F.S. Taccone

12.30 *Lunch Break*

## AMBER HALL 5-6

**MONITORING THE BRAIN WITHOUT  
INVASIVENESS**

Chairpersons: G. Citerio, M. Oddo

9.00 **Automated pupillometry**  
G. Citerio9.15 **Ultrasound**  
C. Robba9.30 **qEEG**  
H. Amirfarzan9.45 **NIRS**  
F.S. Taccone**TREATING TBI IN 2023**

Chairpersons: C. Robba, F.S. Taccone

10.00 **Managing the old and frail TBI: medical and ethical challenges**  
G. Meyfroidt10.15 **Better phenotyping of the patient from out of hospital till ICU**  
G. Citerio10.30 **Controlling intracranial volumes with medical and surgical therapies**  
N. Stocchetti10.45 **Escalating to third tier therapies: is it worth?**  
C. Robba11.00 *Break and Exhibition Visit***DELIRIUM**

Chairpersons: G. Citerio, G. Meyfroidt

11.30 **Update in the identification**  
R. Helbok11.45 **Pharmacological treatment**  
G. Meyfroidt12.00 **The importance of the environment**  
A. Lucchini12.15 **Nursing a patient with delirium**  
A. Negro12.30 *Lunch Break*

## AMBER HALL 7

**ANTONIO BRASCHI'S TUTORIALS  
FOR LIFELONG LEARNING****ANESTHESIA 1**

Presenter: R. Monzani

9.00 **ERAS in abdominal surgery**  
R. Monzani9.30 **ERAS in thoracic surgery**  
G.L. Rosboch10.00 **Difficult intubation between guidelines and clinical practice**  
S. Falchetta10.30 **Preoperative evaluation of the cardiac patient undergoing non-cardiac surgery**  
F. Guarracino11.00 *Break and Exhibition Visit***ANTONIO BRASCHI'S TUTORIALS  
FOR LIFELONG LEARNING****COMMON PROBLEMS IN ICU 2**

Presenter: F. Pinelli

11.30 **Vascular access**  
F. Pinelli12.00 **Sedation and analgesia in ICU**  
G. Russo12.30 *Lunch Break*

## AMBER HALL 8

**ANTONIO BRASCHI'S TUTORIALS  
FOR LIFELONG LEARNING****ULTRASOUND**

Presenter: G. Via

9.00 **Echography head to toe; usefulness in anesthesia and critical care: cranial ultrasound**  
F. Rasulo9.30 **Cardiac arrest: a POCUS approach**  
G. Via10.00 **Lung and diaphragm**  
F. Forfori10.30 **Echography head to toe; usefulness in anesthesia and critical care: lower body**  
F. Corradi11.00 *Break and Exhibition Visit***FRIDAY NIGHT ADMISSION &  
MONDAY MORNING CLINICAL ROUND  
(WITH THE ICU CHIEF!)**

Chairpersons: D. De Luca, C. Robba

11.30 **PATIENT WITH SEVERE BRAIN TRAUMA**  
Friday night admission  
F. Rasulo  
Monday morning round with  
N. Stocchetti12.00 **PATIENT UNDERGOING COMPLICATED CAR-T TREATMENT**  
Friday night admission  
E. Costantini  
Monday morning round with  
V. Fanelli12.30 *Lunch Break*

## BROWN HALL 1

**COMMON ERRORS  
IN CLINICAL PRACTICE**

Chairpersons: M. Antonelli, P. Caironi

9.00 **Common errors in diuretic use in critically ill patients**  
P. Caironi9.20 **Common errors in bicarbonate use**  
F. Duska9.40 **Common errors in setting mechanical ventilation during anesthesia**  
P. Pelosi10.00 **Common errors in managing morbidly obese patients in ICU**  
E. Rezoagli10.20 **Common errors in nutritional support of critically ill patients**  
M.M. Berger10.40 **Common errors in treating a comatose patient**  
R. Helbok11.00 *Break and Exhibition Visit*11.30 - 12.30  
**LET'S DISCUSS ABOUT  
ECPR, FANCY TOOL OR LIFESAVER?**

Presenter: P. Bertini

DISSECTION  
Chairperson: F. Sangalli  
Dissectors: J. Bělohávek, L. Camporota, L. Lamhaut12.30 *Lunch Break*

Friday May 26

AFTERNOON

## AMBER HALL 1-2

## PERIOPERATIVE PAIN MANAGEMENT

Chairpersons: G. Cappelleri, G. Russo

- 14.30 Chronic postsurgical pain: a step forward towards personalized medicine  
D. Bugada
- 14.45 Chronic postsurgical pain: mechanism and treatment  
M. Allegri
- 15.00 Transitional Pain Service: a new model for an old problem  
G. Cappelleri
- 15.15 Future perspectives on prehabilitation Interventions  
G. Michelagnoli
- 15.30 Discussion

## AMBER HALL 3-4

## WHAT WE USE TODAY AND WHAT WE EXPECT TO USE TOMORROW TO TREAT

Chairpersons: M. Antonelli, A. Pesenti

- 14.30 COPD  
S. Nava
- 14.45 Sepsis  
I. Martin-Loeches
- 15.00 AKI  
V. Cantaluppi
- 15.15 Traumatic brain injury  
E. Zanier
- 15.30 Discussion

## AMBER HALL 5-6

## STROKE: CHALLENGES FOR THE FUTURE

Chairpersons: R. Helbok, M. Munari

- 14.30 Defining a system of care for acute stroke: the Lombardia network  
E. Agostoni
- 14.45 Anesthesia and ICU challenges of ischemic stroke  
R. Helbok
- 15.00 Guidelines for the management of SAH patients  
N. Etminan
- 15.15 New strategies for improving SAH outcomes  
G. Citerio
- 15.30 Discussion

Friday May 26

AFTERNOON

## AMBER HALL 7

## ANTONIO BRASCHI'S TUTORIALS FOR LIFELONG LEARNING

## ANESTHESIA 2

Presenter: G. Cortese

- 14.30 Non-cardiac anesthesia in cardiac patient  
M. Senturk
- 15.00 Anesthesia in OSAS patient  
R.M. Corso
- 15.30 Neuromuscular block: will recent new guidelines change our clinical practice?  
G. Cortese

## AMBER HALL 8

12.45 - 14.15

## LUNCH SESSION

## INFEZIONI NEL PAZIENTE CRITICO: ALGORITMI DIAGNOSTICI E TERAPEUTICI

Supported by BIOMERIEUX, THERMO FISHER SCIENTIFIC

Chairpersons: D. Pasero, P. Viale

Il "puzzle" dei biomarcatori in terapia intensiva: nuovi scenari  
G. Montrucchio

Biomarcatori nella terapia delle infezioni gravi  
C. Tascini

Innovazioni ed evidenze nella diagnostica molecolare e fenotipica rapida  
G. Rossolini

Algoritmi decisionali di terapia empirica  
P. Viale

Discussione

Language: Italian, no translation provided

## ANTONIO BRASCHI'S TUTORIALS FOR LIFELONG LEARNING

## MISCELLANEA 2

Presenter: L. Ball

- 14.30 Electrical Impedance Tomography  
G. Bellani
- 15.00 Pressure injuries in the ICU, preventable or not preventable?  
F. Rubulotta
- 15.30 Nebulized drug delivery in intensive care patients  
L. Ball

## BROWN HALL 1

## ACID-BASE AND BLOOD GAS ANALYSIS: A PRACTICAL VIEW

Chairpersons: L. Gattinoni, A. Zanella

- 14.30 Blood gas analysis report: useful and useless values  
S. Brusatori
- 14.45 Unmeasured ions: clinical identification and relevance  
T. Langer
- 15.00 Base excess and SID excess: any difference?  
L. Giosa
- 15.15 Blood gas analysis: here are my secrets  
F. Duska
- 15.30 Discussion

SMART NURSING  
FRIDAY MAY 26

# SMART NURSING

## Faculty

**Bambi S.**, Firenze (I)  
**Caiffa S.**, Genova (I)  
**Comisso I.**, Udine (I)  
**Elli S.**, Monza (I)  
**Fiorillo C.**, Modena (I)  
**Fumagalli R.**, Milano (I)  
**Galazzi A.**, Milano (I)  
**Gawronski O.**, Roma (I)  
**Giusti G.D.**, Perugia (I)  
**Iozzo P.**, Palermo (I)  
**Lucchini A.**, Monza (I)  
**Maino C.**, Monza (I)  
**Manici M.**, Parma (I)  
**Marchese F.**, Palermo (I)  
**Minotti D.**, Monza (I)  
**Moggia F.**, Genova (I)  
**Monesi A.**, Bologna (I)  
**Negro A.**, Milano (I)  
**Scelsi S.**, Genova (I)

## BROWN HALL 2

## MORNING

### MONITORAGGIO EMODINAMICO NEL PAZIENTE CRITICO

Moderatori: S. Elli, M. Manici

9.30 **Monitoraggio emodinamico: le basi**  
R. Fumagalli

9.45 **Monitoraggio emodinamico:  
dalle basi agli strumenti avanzati**  
I. Comisso

10.00 **Farmaci vasopressori**  
C. Fiorillo

10.15 **Pompe a siringa e farmaci vasopressori**  
A. Lucchini

10.30 **Discussione**

11.00 *Break and Exhibition Visit*

### LESIONI DA PRESSIONE NEI PAZIENTI CRITICI: UN VECCHIO E NUOVO PROBLEMA

Moderatori: P. Iozzo, S. Scelsi

11.30 **Le lesioni da pressione nel paziente critico**  
A. Galazzi

11.45 **Strategie per la prevenzione delle lesioni nel  
paziente critico**  
C. Maino

12.00 **La mobilitazione precoce in terapia intensiva**  
S. Caiffa

12.15 **Discussione**

12.30 *Lunch Break*

## BROWN HALL 2

## AFTERNOON

### HOT TOPICS NELL' ASSISTENZA INFERMIERISTICA DEL PAZIENTE CRITICO

Moderatori: G. D. Giusti, A. Negro

14.30 **Come cambiano i parametri vitali durante e  
dopo gli interventi infermieristici**  
F. Marchese

14.45 **Igiene orale e clorexidina nei pazienti critici:  
una storia senza fine**  
S. Bambi

15.00 **Il bagno a letto con la clorexidina: quando sì,  
quando no**  
P. Iozzo

15.15 **Quale ruolo per gli infermieri di terapia  
intensiva nel Medical Emergency Team?**  
D. Minotti

15.30 **Early Warning System al letto del paziente  
pediatrico**  
O. Gawronsky

15.45 **Il Trauma Nurse Leader nella realtà italiana**  
A. Monesi

16.00 **Gli infermieri hanno bisogno di "Ultrasound  
Training"?**  
F. Moggia

16.15 **Discussione**

# FRIDAY MAY 26

OFFICIAL LANGUAGE: ITALIAN ONLY, NO SIMULTANEOUS TRANSLATION.

## WESMART SESSIONS

---

- ▶ Complementary sessions detailed in the following pages will take place in either of the two open spaces in the Exhibition Area, the new **WeSmart Space 1** and **WeSmart Space 2**. Admission is free or by invitation. Capacity: 50 seats each (approx.), unless otherwise stated due to COVID-19 pandemic restrictions. Both WeSmart Spaces are equipped with noise-cancelling earphones.

*Le sessioni complementari riportate alle pagine che seguono si svolgeranno in uno dei due open space presenti nell'Area Espositiva, denominati **WeSmart Space 1** e **WeSmart Space 2**. L'accesso per la partecipazione alle sessioni è libero o ad invito. Capienza: 50 posti circa ciascuno, fatte salve eventuali disposizioni restrittive per il contenimento dell'epidemia da COVID-19. Entrambi gli spazi sono provvisti di auricolari per l'isolamento acustico.*

- ▶ **Language: English or Italian, no simultaneous translation.**  
*Lingua: Inglese o Italiano, senza traduzione simultanea.*

## WESMART SESSIONS

MAY 24

## WeSmart Space 2

WEDNESDAY  
MAY 24  
11.30 - 12.30

**L'OTTIMIZZAZIONE DEL MONITORAGGIO DURANTE LA VENTILAZIONE MECCANICA PER MIGLIORARE L'OUTCOME**  
Speakers: **D. Chiumello, L. Gattinoni**

Supported by: WEDNESDAY  
MAY 24  
13.00 - 14.00

**ADVANCED PERIOPERATIVE HEMODYNAMIC MONITORING**

**A "smart filter" to assure reliability of arterial pressure waveforms and hemodynamic data**  
S. Romagnoli

**Stroke volume optimization in the perioperative period**  
A. Messina

**Affordable solutions for advanced hemodynamic assessment**  
F. Michard

Un Lunch Bag sarà offerto ai partecipanti

Supported by: 

## WESMART SESSIONS

MAY 25

## WeSmart Space 1

THURSDAY  
MAY 25  
10.00 - 11.00

**HOW TO MANAGE FUNGAL INFECTIONS IN MY NEXT PATIENT**

Chairperson: **M. Girardis**

**Antifungal therapy: one size does not fit all**  
F. Pea

**Intra-Abdominal Candidiasis in critically ill patients: practical management**  
M. Bartoletti

Con il contributo non condizionante di: THURSDAY  
MAY 25  
11.30 - 12.30

**OLTRE LA CURA E IL PRENDERSI CURA: L'IMPORTANZA DELLA COMUNICAZIONE CON IL PAZIENTE "VOICELESS" IN TERAPIA INTENSIVA**

Speakers: **G. Bellani, L. Cabrini, C. Capra, G. Spinazza**Supported by: THURSDAY  
MAY 25  
16.00 - 17.00

**USO DI UN SISTEMA DI INFUSIONE RAPIDA NELL'EMORRAGIA CRITICA**

Chairperson: **M. Girardis**

**Gestione del paziente traumatizzato**  
R. Fumagalli

**Gestione del paziente chirurgico**  
A. Siniscalchi

Supported by: 

## WeSmart Space 2

THURSDAY  
MAY 25  
13.30 - 14.30

**DALL'ECMO ALL'HFNC: NUOVI E VECCHI CONCETTI DI UMIDIFICAZIONE**

**Perché, quanto e come umidificare**  
G. Foti

**Quali i device più funzionali e come utilizzarli**  
A. Lucchini

Un Lunch Bag sarà offerto ai partecipanti

Supported by: THURSDAY  
MAY 25  
16.00 - 17.00

**MACHINE LEARNING E MONITORAGGIO EMODINAMICO AVANZATO: NUOVI PARAMETRI PREDITTIVI PER LA GESTIONE PERIOPERATORIA DEL PAZIENTE**

**Monitoraggio predittivo e proattivo in chirurgia non cardiaca**  
M. Cecconi

**Monitoraggio emodinamico predittivo in chirurgia cardiaca**  
F. Guarracino

**Discussione casi clinici con HPI (Hypotension Prediction Index)**  
L. Frassanito

Supported by: 

## WeSmart Space 1

FRIDAY  
MAY 26  
11.30 - 12.30**PREVENTING VILI: ROLE OF EXTRACORPOREAL CO<sub>2</sub> REMOVAL (ECCO<sub>2</sub>-R)****The importance of avoiding VILI and rationale of ECCO<sub>2</sub>-R**  
L. Gattinoni**ECCO<sub>2</sub>-R as lung protective strategy in clinical practice**  
M. Hilty

Q/A and Discussion

Supported by: 

## WeSmart Space 2

FRIDAY  
MAY 26  
12.30 - 13.30**NEW HORIZONS IN EXTRACORPOREAL BLOOD PURIFICATION: ADSORPTION OF PATHOGENS WITH SERAPH 100****Immunomodulation and pathophysiological response in ICU patients. Are we considering all therapeutic options?**  
M. Girardis**What's new on hemoperfusion in critically ill patients**  
S. De Rosa**From registry to patient bedside: Italian experiences on adsorption of pathogens**  
G. Paternoster

Un Lunch Bag sarà offerto ai partecipanti

Supported by: 

## MEET THE EXPERT

**Meet the Expert** sessions offer the opportunity of free talks with recognized experts on topics of interest. They take place in the **Meet the Expert Point**, an open space in the Exhibition Area with 30 seats. Free access until full capacity is reached, no registration required. Language: English or Italian, no simultaneous translation.

*I Meet the Expert offrono la possibilità di una chiacchierata informale con esperti riconosciuti su argomenti di particolare interesse. Si svolgono nel Meet the Expert Point, uno spazio aperto situato nell'Area Espositiva, con 30 posti a sedere. Accesso libero e gratuito, senza necessità di registrazione, fino ad esaurimento posti. Lingua: Inglese o Italiano, senza traduzione simultanea.*

## Meet the Expert Point

## WEDNESDAY MAY 24

11.00 - 11.45

**FREE TALKS ON WELL-BEING OF ICU STAFF**

Experts: A. Giannini, N. Nielsen

15.00 - 15.45

**FREE TALKS ON BLEEDING DURING SURGERY**

Experts: E. De Robertis, M. Panigada

## Meet the Expert Point

## THURSDAY MAY 25

11.00 - 11.45

**PEEP SELECTION: ANY ROLE FOR ELECTRICAL IMPEDANCE TOMOGRAPHY (EIT)?**

Experts: D. Chiumello, D.L. Grieco

16.00 - 16.45

**FREE TALKS ON POSTOPERATIVE COMPLICATIONS**

Experts: L. Cabrini, A. Pedoto

## Meet the Expert Point

## FRIDAY MAY 26

11.00 - 11.45

**FREE TALKS ON BLEEDING IN TRAUMA**

Experts: V. Agostini, N. Rachedi

# SIMULATION SESSIONS

---

- ▶ **Language: English or Italian, no simultaneous translation.**  
*Lingua: Inglese o Italiano, senza traduzione simultanea.*



SIMULATION SESSIONS  
MAY 24

1

Simulation Center

WEDNESDAY MAY 24 | 11.00 - 12.00

Supported by  **flexicare**  
TOTAL QUALITY - TOTAL CARE

## SIMULATION SESSION

## ANESTESIA

SPEAKERS: **G. Cortese, M. Leo****INTUBAZIONE VIDEO-GUIDATA, UNA NUOVA METODICA DALL'ANESTESIA GENERALE ALL'AWAKE**  
VIDEO GUIDED INTUBATION, A NEW METHOD FROM GENERAL ANESTHESIA TO AWAKE TRACHEAL INTUBATION (ATI)

Lo scopo di questo scenario di simulazione è offrire ai partecipanti una panoramica completa dei diversi approcci fruibili nella gestione delle vie aeree ed i vantaggi che la tecnologia può mettere a disposizione del clinico. Verrà descritta la video-intubazione del paziente in anestesia generale, l'intubazione ibrida, l'awake video-intubation con approccio posteriore e l'awake video-intubation con approccio anteriore. Per ogni tecnica descritta verranno illustrati i criteri di scelta, le indicazioni e le controindicazioni. Verranno infine trattati la preparazione ed il corretto posizionamento del paziente.

Partecipazione a numero chiuso (max 40 posti) con preiscrizione obbligatoria.  
Le iscrizioni saranno accettate in base all'ordine di arrivo, fino ad esaurimento posti.  
Dettagli a pagina 65. Per partecipare è necessario essere iscritti allo SMART.

1

Simulation Center

WEDNESDAY MAY 24 | 12.30 - 13.30

Supported by  **GETINGE**

## SIMULATION SESSION

VENTILAZIONE  
MECCANICASPEAKERS: **D. Colombo, A. Costa****DALL'OTTIMIZZAZIONE DEL PRESSURE SUPPORT ALLA VENTILAZIONE PROPORZIONALE: COME IL SEGNALE Vitale Edì PUÒ CAMBIARE L'APPROCCIO AL PAZIENTE CRITICO, QUALI NOVITÀ.**

Lo scopo di questo scenario di simulazione è offrire ai partecipanti un training sui vantaggi derivanti dalla comprensione e dall'utilizzo del segnale vitale Edì (attività elettrica del diaframma) per sincronizzare la ventilazione assistita standard ed i principali parametri ventilatori. Verranno inoltre discussi i vantaggi che possono derivare dall'applicazione di una ventilazione avanzata proporzionale all'effettivo sforzo neurale del paziente e saranno illustrate le novità oggi a disposizione del clinico.

Partecipazione a numero chiuso (max 40 posti) con preiscrizione obbligatoria.  
Le iscrizioni saranno accettate in base all'ordine di arrivo, fino ad esaurimento posti.  
Dettagli a pagina 65. Per partecipare è necessario essere iscritti allo SMART.

SIMULATION SESSIONS  
MAY 24

1

Simulation Center

WEDNESDAY MAY 24 | 14.00 - 15.00

## SIMULATION SESSION

SEDAZIONE E  
ANALGESIASPEAKERS: **G. Cortese, F. Barbani****STRATEGIA PER UNA SEDAZIONE SICURA**

Durante questa simulazione sarà offerta ai partecipanti la possibilità di riflettere sui principali aspetti che permettono di migliorare la sicurezza del paziente sottoposto a Sedazione ed Analgesia Procedurale (SAP). Le complicanze che avvengono più frequentemente in corso di SAP, come anche nel paziente in Post-Anesthesia Care Unit, sono la compromissione delle vie aeree e la riduzione del drive respiratorio; in entrambi i casi, un corretto monitoraggio strumentale può garantire una diagnosi precoce per la prevenzione di ulteriori danni. In taluni contesti è consentita la somministrazione di SAP da parte di personale sanitario non-anestesista adeguatamente formato, in stretta collaborazione con gli anestesisti di riferimento. L'implementazione del corretto monitoraggio strumentale per la SAP è in questo contesto ancor più utile per garantire la sicurezza del paziente.

Partecipazione a numero chiuso (max 40 posti) con preiscrizione obbligatoria.  
Le iscrizioni saranno accettate in base all'ordine di arrivo, fino ad esaurimento posti.  
Dettagli a pagina 65. Per partecipare è necessario essere iscritti allo SMART.

1

Simulation Center

WEDNESDAY MAY 24 | 16.30 - 18.00

Supported by  **EUROSETS**  
EVERY LIFE MATTERS

## SIMULATION SESSION

## EMERGENZA

SPEAKERS: **P. Bertini, G. Paternoster, F. Sangalli****eCPR CHEAT SHEET: A SIMULATION SCENARIO**

Lo scopo di questo scenario di simulazione è fornire le basi pratiche per la gestione del paziente che giunge in arresto cardiaco refrattario in Pronto Soccorso ed è candidato ad eCPR. Lo scenario prevederà una simulazione di incannulazione in stile MegaCode seguita da debriefing.

Partecipazione a numero chiuso (max 40 posti) con preiscrizione obbligatoria.  
Le iscrizioni saranno accettate in base all'ordine di arrivo, fino ad esaurimento posti.  
Dettagli a pagina 65. Per partecipare è necessario essere iscritti allo SMART.

SIMULATION SESSIONS  
MAY 25

1

Simulation Center

THURSDAY MAY 25 | 10.00 - 11.00

Supported by  **EUROSETS**  
EVERY LIFE MATTERS

## SIMULATION SESSION

SPEAKERS: **J. Bělohávek, L. Camporota, M. Quintel**

## ECMO

**INSIGHTS INTO THE ECMO HUB & SPOKE MODEL:  
LOGISTICAL, CLINICAL AND TECHNICAL CHALLENGES****Setting up an out-of-hospital e-CPR clinical and research program**  
J. Bělohávek**Delivering a Regional Centre for ECMO Support: factors affecting outcomes**  
L. Camporota**How to set up a Hub & Spoke program: teams and training**  
M. Quintel*Admission is limited to max 40 participants with mandatory pre-registration. Registrations will be accepted on a first-come first-served basis depending on availability. Participants are requested to be registered to the SMART meeting. Details on page 65.*

1

Simulation Center

THURSDAY MAY 25 | 12.00 - 13.00

Supported by  **Dräger**

## SIMULATION SESSION

SPEAKERS: **G. Foti, E. Rezoagli**VENTILAZIONE  
MECCANICA**RECLUTAMENTO ALVEOLARE E IMPOSTAZIONE DELLA PEEP  
IN BASE ALLA MECCANICA RESPIRATORIA**

Lo scopo di questo scenario di simulazione è offrire ai partecipanti un training sui possibili approcci utilizzabili per realizzare manovre di reclutamento alveolare e per dosare la PEEP in base ai dati derivati dalle misure di meccanica respiratoria. Saranno simulate le alterazioni patologiche più rilevanti di questi parametri e ne saranno discusse le implicazioni cliniche.

*Partecipazione a numero chiuso (max 40 posti) con preiscrizione obbligatoria. Le iscrizioni saranno accettate in base all'ordine di arrivo, fino ad esaurimento posti. Dettagli a pagina 65. Per partecipare è necessario essere iscritti allo SMART.*SIMULATION SESSIONS  
MAY 25

1

Simulation Center

THURSDAY MAY 25 | 14.00 - 15.00

Supported by  **Baxter**

## SIMULATION SESSION

SPEAKERS: **M. Rossi, C. Memoli**SETTING  
OPERATORIO/TIPO**FLUID RESPONSIVENESS E SUA VALUTAZIONE ATTRAVERSO IL  
MONITORAGGIO EMODINAMICO NON INVASIVO REACTANCE-BASED**

Lo scopo principale di questo scenario di simulazione è introdurre i partecipanti all'utilizzo di un monitoraggio emodinamico del flusso centrale, non invasivo, basato sulla tecnologia della Reattanza, utile alla valutazione della fluid responsiveness del paziente in ambito perioperatorio e critico. Questa tecnologia permette un impiego dei farmaci appropriato, evidence-based, realizzando una "individualized gold-directed fluid therapy" con conseguente miglioramento dell'outcome del paziente.

*Partecipazione a numero chiuso (max 40 posti) con preiscrizione obbligatoria. Le iscrizioni saranno accettate in base all'ordine di arrivo, fino ad esaurimento posti. Dettagli a pagina 65. Per partecipare è necessario essere iscritti allo SMART.*

1

Simulation Center

THURSDAY MAY 25 | 16.00 - 17.00

Supported by  **Medigas**

## SIMULATION SESSION

SPEAKERS: **G. Scaramuzza, C.A. Volta, A. Zanella**VENTILAZIONE  
MECCANICA**NUOVI APPROCCI NELLA VENTILAZIONE MECCANICA****Sistema innovativo per la gestione delle secrezioni tracheali nel paziente intubato**  
A. Zanella**Nuovi approcci nel setting del ventilatore**  
G. Scaramuzza, C.A. Volta*Partecipazione a numero chiuso (max 40 posti) con preiscrizione obbligatoria. Le iscrizioni saranno accettate in base all'ordine di arrivo, fino ad esaurimento posti. Dettagli a pagina 65. Per partecipare è necessario essere iscritti allo SMART.*

## HIGH FIDELITY SIMULATION SESSIONS

MAY 24

Supported by **Accurate**  
Learn. Practice. Improve.

La simulazione è oggi diventata parte integrante e fondamentale della crescita degli operatori sanitari, sempre più evidence-based e centrata sulle abilità tecniche e non tecniche, sul teamwork, la leadership ed il problem solving. Scopo dell'High Fidelity Simulation in sede congressuale è riproporre ai discenti scenari di vita reale (secondo le regole del CRM), strutturati con l'obiettivo di implementare le proprie abilità e lavorare in tutta sicurezza al di fuori dalla propria "comfort zone". Le sessioni prevedono l'utilizzo di simulatori avanzati di ultima generazione. I partecipanti saranno al tempo stesso attori e spettatori: chiunque vorrà cimentarsi potrà entrare nel gioco... vi aspettiamo numerosi!

Simulation Center

WEDNESDAY MAY 24 | 10.00 - 11.00

2

SPEAKER: **A. Andreotti - Team Tecnico Accurate**CHAMPIONS LEAGUE  
ROAD TO SMART 2023CHAMPIONS  
LEAGUE

## SEMIFINALE 1: TORINO 1 vs. SIENA

Prima semifinale della competizione a squadre **CHAMPIONS LEAGUE - ROAD TO SMART 2023** riservata a team di Medici in Formazione Specialistica.

Nella prima semifinale si sfideranno due dei 4 team che sono risultati vincitori nei 2 gironi disputati presso il **Centro di Simulazione SimulaHub** di Parma.

Il team vincitore della semifinale disputerà la finalissima che si svolgerà in questa stessa sede giovedì 25 maggio alle ore 10.00.

Partecipazione libera e gratuita, a numero chiuso, fino ad esaurimento posti (max 30 persone). Per partecipare è necessario essere iscritti allo SMART.

Simulation Center

WEDNESDAY MAY 24 | 11.30 - 13.30

2

SPEAKERS: **A. Andreotti, L. Dall'Ara & Team Tecnico Accurate**SPECIAL GUEST: **F. Forfori**

## ESCAPE ROOM: ARDS E SHOCK SETTICO

Sepsi, insufficienza respiratoria e quanto altro... in un complicato copione di Terapia Intensiva. Quali strategie, trucchi e terapie rescue utilizzare se il tuo paziente peggiora, ha una sorgente non controllata e lo devi ventilare a pressione positiva. Interessante challenge e "views' exchange" in simulazione avanzata.

Partecipazione a pagamento, a numero chiuso, fino ad esaurimento posti (max 30 persone). Dettagli a pagina 65. Per partecipare è necessario essere iscritti allo SMART.

HIGH FIDELITY  
SIMULATION  
1

## HIGH FIDELITY SIMULATION SESSIONS

MAY 24

Simulation Center

WEDNESDAY MAY 24 | 14.30 - 15.30

2

SPEAKER: **A. Andreotti - Team Tecnico Accurate**CHAMPIONS LEAGUE  
ROAD TO SMART 2023

## SEMIFINALE 2: BOLOGNA vs. PARMA

Seconda semifinale della competizione a squadre **CHAMPIONS LEAGUE - ROAD TO SMART 2023** riservata a team di Medici in Formazione Specialistica.

Nella seconda semifinale si sfideranno due dei 4 team che sono risultati vincitori nei 2 gironi disputati presso il **Centro di Simulazione SimulaHub** di Parma.

Il team vincitore della semifinale disputerà la finalissima che si svolgerà in questa stessa sede giovedì 25 maggio alle ore 10.00.

Partecipazione libera e gratuita, a numero chiuso, fino ad esaurimento posti (max 30 persone). Per partecipare è necessario essere iscritti allo SMART.

CHAMPIONS  
LEAGUE

Simulation Center

WEDNESDAY MAY 24 | 16.30 - 18.30

2

SPEAKERS: **A. Andreotti, L. Dall'Ara & Team Tecnico Accurate**SPECIAL GUEST: **A. Costamagna**

## TRICK OR TREAT SU ARRESTO, PERI-ARRESTO E GESTIONE POST-ROSC

Trucchi e skills sulla gestione del peri-arresto e di tutte le condizioni di arresto cardio-circolatorio: come implementare ROSC, trattamento ed outcome del paziente nei diversi setting in cui operiamo... dai primi secondi alla dimissione. Non la solita gestione, ma un approccio differente e ragionato che sappia vedere oltre la linea guida.

Partecipazione a pagamento, a numero chiuso, fino ad esaurimento posti (max 30 persone). Dettagli a pagina 65. Per partecipare è necessario essere iscritti allo SMART.

HIGH FIDELITY  
SIMULATION  
2

## HIGH FIDELITY SIMULATION SESSIONS

MAY 25

Simulation Center

THURSDAY MAY 25 | 10.00 - 11.00

2

CHAMPIONS  
LEAGUESPEAKER: **A. Andreotti - Team Tecnico Accurate**CHAMPIONS LEAGUE  
ROAD TO SMART 2023

## FINALISSIMA

Finalissima della competizione a squadre **CHAMPIONS LEAGUE - ROAD TO SMART 2023** riservata a team di Medici in Formazione Specialistica. Nella finalissima si sfideranno i due team vincitori delle semifinali. La cerimonia di premiazione dei vincitori si svolgerà in questa stessa sede **Giovedì 25 Maggio** nel pomeriggio.

Partecipazione libera e gratuita, a numero chiuso, fino ad esaurimento posti (max 30 persone). Per partecipare è necessario essere iscritti allo SMART.

Simulation Center

THURSDAY MAY 25 | 11.30 - 13.30

2

HIGH FIDELITY  
SIMULATION  
3SPEAKERS: **A. Andreotti, L. Dall'Ara & Team Tecnico Accurate**  
SPECIAL GUEST: **A. Mancino**TRANQUILLI... HA CHIAMATO IL 118  
E STA ARRIVANDO UN BAMBINO *Sessione 1*

Dalla classica chiamata che non vorresti mai ricevere, ai classici problemi che non ti aspetti... Gestione del bambino critico in emergenza tramite Simulatore Pediatrico Avanzato ed un team di esperti "pediatrici" con cui confrontarsi. Challenge ad elevata competence technical e non-technical sul bambino che nessuno vorrebbe mai incontrare...

Partecipazione a pagamento, a numero chiuso, fino ad esaurimento posti (max 30 persone). Dettagli a pagina 65. Per partecipare è necessario essere iscritti allo SMART.

Simulation Center

THURSDAY MAY 25 | 14.30 - 16.30

2

HIGH FIDELITY  
SIMULATION  
4SPEAKERS: **A. Andreotti, L. Dall'Ara & Team Tecnico Accurate**  
SPECIAL GUEST: **S. Busani**PRE-ECLAMPسيا ED EMERGENZE IN SALA PARTO:  
WHAT ELSE? *Sessione 1*

So far so good... ma solo fino ad ora! Benvenuti infatti nel terzo trimestre di gravidanza dove pre-eclampsia, eclampsia, sepsi puerperale e PPHD saranno la sfida da saper accettare e trattare, fino alla stabilizzazione della paziente. Nell'unico contesto capace di una mortalità del 200%, ogni scelta su madre e feto sarà attentamente da ponderare.

Partecipazione a pagamento, a numero chiuso, fino ad esaurimento posti (max 30 persone). Dettagli a pagina 65. Per partecipare è necessario essere iscritti allo SMART.

## HIGH FIDELITY SIMULATION SESSIONS

MAY 26

Simulation Center

FRIDAY MAY 26 | 9.00 - 11.00

2

HIGH FIDELITY  
SIMULATION  
5SPEAKERS: **A. Andreotti, L. Dall'Ara & Team Tecnico Accurate**  
SPECIAL GUEST: **G. Cortese**QUANDO IL PAZIENTE CRITICO È ANCORA PIÙ CRITICO:  
TECHNICAL E NON TECHNICAL SKILLS IN INTENSIVE CARE

Miscellanea di casi e pazienti critici, dalla Shock Room all'Intensive Care, durante un normale pomeriggio di guardia: challenge dinamica su tutto ciò che non vorresti succedesse... ma succede! Dalla via aerea imprevista, allo shock refrattario, alla necessità di trasferire il paziente, dovrai essere in grado di sapertela cavare nell'ambiente più ostile di tutti: l'Ospedale.

Partecipazione a pagamento, a numero chiuso, fino ad esaurimento posti (max 30 persone). Dettagli a pagina 65. Per partecipare è necessario essere iscritti allo SMART.

Simulation Center

FRIDAY MAY 26 | 11.30 - 13.30

2

HIGH FIDELITY  
SIMULATION  
6SPEAKERS: **A. Andreotti, L. Dall'Ara & Team Tecnico Accurate**  
SPECIAL GUEST: **L. Bussolin**TRANQUILLI... HA CHIAMATO IL 118  
E STA ARRIVANDO UN BAMBINO *Sessione 2*

Dalla classica chiamata che non vorresti mai ricevere, ai classici problemi che non ti aspetti... Gestione del bambino critico in emergenza tramite Simulatore Pediatrico Avanzato ed un team di esperti "pediatrici" con cui confrontarsi. Challenge ad elevata competence technical e non-technical sul bambino che nessuno vorrebbe mai incontrare...

Partecipazione a pagamento, a numero chiuso, fino ad esaurimento posti (max 30 persone). Dettagli a pagina 65. Per partecipare è necessario essere iscritti allo SMART.

Simulation Center

FRIDAY MAY 26 | 14.30 - 16.30

2

HIGH FIDELITY  
SIMULATION  
7SPEAKERS: **A. Andreotti, L. Dall'Ara & Team Tecnico Accurate**  
SPECIAL GUEST: **S. Busani**PRE-ECLAMPسيا ED EMERGENZE IN SALA PARTO:  
WHAT ELSE? *Sessione 2*

So far so good... ma solo fino ad ora! Benvenuti infatti nel terzo trimestre di gravidanza dove pre-eclampsia, eclampsia, sepsi puerperale e PPHD saranno la sfida da saper accettare e trattare, fino alla stabilizzazione della paziente. Nell'unico contesto capace di una mortalità del 200%, ogni scelta su madre e feto sarà attentamente da ponderare.

Partecipazione a pagamento, a numero chiuso, fino ad esaurimento posti (max 30 persone). Dettagli a pagina 65. Per partecipare è necessario essere iscritti allo SMART.

# ORAL PRESENTATIONS AND E-POSTERS

---

► **Language: English, no simultaneous translation.**  
*Lingua: Inglese, senza traduzione simultanea.*

**PEDIATRICS**Chairpersons: **G. Conti, A. Giannini****Paediatric traumatic brain injury compared with adults and elderly.****A CENTER-TBI analysis on intracranial pressure treatment and outcomes**

M. Consonni, B. Noè, F. Graziano, M. Amigoni, P. Mangili, J. Pizzagalli, A. Vargiolu, F. Mulazzani, G. Pastore, G. Citerio

**Traumatic Brain Injury in different age groups: a CENTER-TBI analysis on clinical presentation, surgical treatment and second insults**

B. Noè, M. Consonni, F. Graziano, F. Magni, R. Abbate, A. Addis, C. Giovannoni, F. Mulazzani, G. Pastore, G. Citerio

**Assessment of the effect of CO<sub>2</sub> insufflation on regional Cerebral Oxygen Saturation using Near InfraRed Spectroscopy in children undergoing robotic-assisted laparoscopic pyeloplasty (RALP)**  
C.M. Lapenta, S. Franzini, M. Brebion, S. Querciagrossa, M. Hidalgo, T. Blanc, G. Orliaguet**Can turbine ventilators in infants affected by acute bronchiolitis help in case of outbreak? A retrospective safety study**

D. Guarracino, M.A. Figini, L. Ughi, T. Marchesi, S. Scalia Catenacci, G. Babini, L. Orlandi, V. Figgiaconi, C. Villa, G. Chidini

**Variations in distribution of ventilation measured with Electrical Impedance Tomography (EIT) in pediatric patient with acute respiratory failure during non-invasive ventilation**

V. Figgiaconi, T. Marchesi, S. Scalia Catenacci, L. Ughi, G. Babini, L. Orlandi, M.A. Figini, C. Villa, G. Chidini

**ICU VENTILATION 1**Chairpersons: **G. Grasselli, S. Jaber****Conservative versus liberal oxygenation targets in intensive care unit patients: a multicentre randomized clinical trial**

I. Van Der Wal, C. Grim, D. Van Westerloo, P. Pelosi, M. Schultz, H. Helmerhorst, E. De Jonge

**Characteristics and outcomes of patients with acute myeloid leukemia admitted to Intensive Care Unit with acute respiratory failure: a post-hoc analysis of the EFRAIM prospective multicenter study**

C. Secreto, M. Cerrano, A. Kouatchet, E. Lengliné, J. Rello, F. Pene, V. Lemiale, M. Darmon, I. Martin-Loeches, E. Azoulay, D. Mokart

**The mechanical power ratio: a possible threshold**

M. Velati, R. D'Albo, I. Fratti, T. Pozzi, A. Fioccola, R.V. Nicolardi, F. Lombardo, S. Gattarello, M. Busana, F. Romitti, O. Moerer, L. Gattinoni

**Relationship between longitudinal changes of respiratory mechanics, mechanical power, gas exchange and intensive care outcome in ARDS patients**

G. Catozzi, T. Pozzi, I. Fratti, A. Soldano, F. Cucinotta, M. Chioccola, F. Davi, F. Becci, S. Coppola, D. Chiumello

**Specific respiratory system compliance in COVID-19 and non COVID-19 ARDS**

T. Pozzi, R. D'Albo, A. Fioccola, I. Fratti, F. Lombardo, R.V. Nicolardi, M. Velati, M. Busana, F. Romitti, O. Moerer, K. Meissner, L. Gattinoni

**NEURO CASE REPORTS**Chairpersons: **M. Raimondi, F.S. Taccone****A preliminary prognostication for good neurological outcome in the patient with postcardiac arrest care: how to reduce an inappropriate withdrawal of life-sustaining therapy in early stage?**

S. Lee, C. Kang

**Time window for blood-brain barrier disruption as triggers of vasogenic cerebral oedema in hypoxic-ischemic brain injury after cardiac arrest**

C. Kang, Y. Yeonho, P. Jung Soo

**Anesthetic management during thrombectomy for posterior circulation ischemic stroke: a descriptive analysis**

R. Natoli, F. Bernasconi, A. Macera, M. Piano, A. Cervo, G. Pero, A. Chieregato

**Early systemic insults after traumatic brain injury. A CENTER-TBI study on 1,695 ICU patients**

G. Pastore, F. Graziano, C. Robba, M. Sivero, F. Mulazzani, B. Noè, M. Consonni, M.G. Abate, C. Quaranta, E. Colombo, D. Savo, G. Citerio

**In-situ medical emergency call simulation: an hospital-wide quality improvement project aiming at improving patient safety and staff confidence with cardiopulmonary resuscitation**

L. Carenzo, E. Costantini, V. Prina, M. Muzio, M. Cecconi

**ICU MONITORING: FROM BENCH TO BEDSIDE**Chairpersons: **L. Brazzi, A. Messina****Estimate of oxygen extraction ratio with an arterial and central venous blood sample: analysis on a preclinical trial**

A. Fioccola, T. Pozzi, I. Fratti, M. Velati, R. D'Albo, R.V. Nicolardi, F. Lombardo, M. Busana, S. Gattarello, O. Moerer, K. Meissner, F. Romitti, L. Gattinoni

**Sodium to potassium ratio during urinary electrolytes continuous monitoring as a surrogate of intravascular volume trends and cardiac output in mechanically ventilated piglets: preliminary data from a preclinical trial**

A. Fioccola, R. D'Albo, I. Fratti, T. Pozzi, R.V. Nicolardi, M. Velati, F. Lombardo, M. Busana, S. Gattarello, K. Meissner, O. Moerer, F. Romitti, L. Gattinoni

**Predictive pressure hemodynamic markers of acute kidney injury**

F. Lombardo, M. Busana, R. D'Albo, S. Gattarello, M. Velati, I. Fratti, R.V. Nicolardi, T. Pozzi, A. Fioccola, F. Romitti, L. Gattinoni

**Assessing the variation in respiratory mechanics and lung volumes during percutaneous tracheostomy: focus on Electrical Impedance Tomography monitoring**

R. Garberi, L. Bastia, M. Docci, C. Cipolla, M. Zaniboni, F. Curto, R. Fumagalli, A. Chieregato

**Sodium alterations during continuous veno-venous renal replacement therapy**

B. Brunoni, F. Zadek, F. Mulazzani, M. Favarato, G. Tettamanti, S. Spezia, M. Figini, A. Pala, C.M. Bonenti, F. Tardini, T. Langer, R. Fumagalli

**ICU VENTILATION 2**Chairpersons: **G.A. Iotti, F. Raimondi****Chest wall loading during supine and prone position in patients with COVID-19 ARDS: effects on respiratory mechanics and gas exchange**

M. Umbrello, S. Lassola, A. Sanna, R. Pace, S. Magnoni, G. Bellani, S. Miori

**Modulation of pulmonary blood flow in patients with acute respiratory failure**

S. Spina, F. Marrazzo, C.C.A. Morais, C. Forlini, R. Giudici, G. Bassi, M. Amato, T. Langer, L. Berra, R. Fumagalli

**PEEP titration is markedly affected by trunk inclination in mechanically ventilated patients with ARDS: a physiologic, cross-over study**

F. Marrazzo, S. Spina, F. Zadek, C. Forlini, G. Bassi, R. Giudici, G. Bellani, R. Fumagalli, T. Langer

**Changes in lung aeration and venous admixture with higher PEEP in COVID-19 related ARDS: a CT scan study**

C. Mercalli, A. Santini, M. Ferrari, F. Pennati, A. Aliverti, A. Protti, M. Cecconi

**Routine screening CT in V-V ECMO: incidental findings and clinical impact**

P. Collins, L. Giosa, S. Kathar, V. Camarda, F. Palesino, D. Eshwar, N. Barrett, A. Retter, B. Sanderson., L. Camporota

APP TO **SMART**

the SMART meeting at your fingertips

Real time interaction, ballot system and all SMART info at a glance!

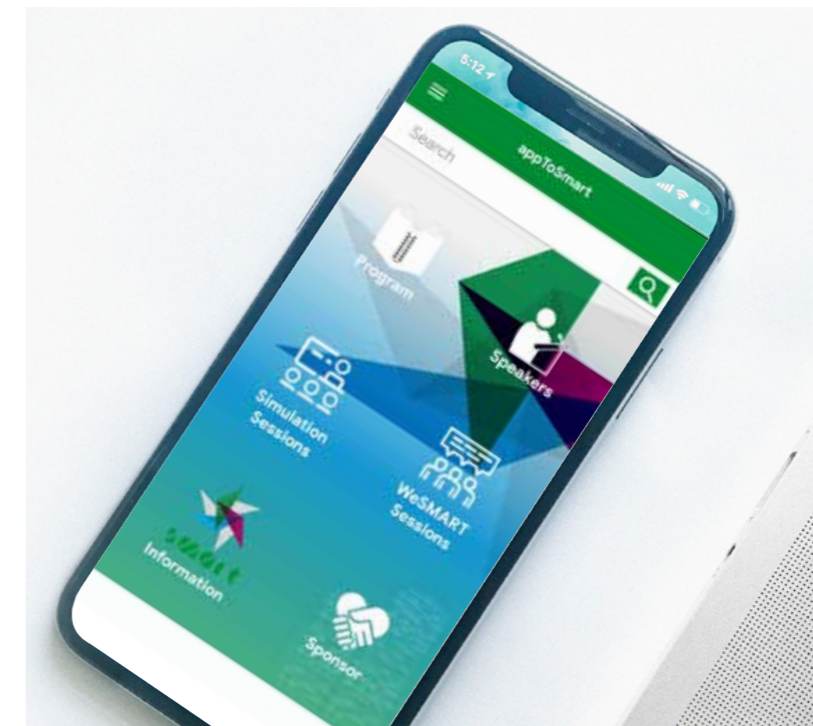
**Download the app**on [www.smartonweb.org](http://www.smartonweb.org) or directly on **App Store** for Apple Products and **Google Play** for Android Products.

## E-POSTER CORNER 1

Wednesday  
May 24

## DISCUSSION

h. 13.00 - 14.30

## BIOMARKERS AND INFECTIONS

Chairpersons: G. Montrucchio, D. Pasero

- P 1** Do Presepsin (PSEP) and other inflammatory markers correlate with microbiological culture results in sepsis?  
G. Anzelmo, P. Ferrari, V. Moioli, A. Marino, F. Fabretti
- P 2** Pancreatic stone protein (PSP) as antibiotic therapy marker  
D. Filippi, I. Riva, P. Ferrari, F.A. Rasulo, A. Marino, F. Fabretti
- P 3** Role of PCT in identification of ICU secondary infections in severe COVID-19 patients: a retrospective study  
S. Campani, M. Talamonti, L. Dall'Ara, I. Gatto, M. Girardis
- P 4** Prognostic value of mid-regional proadrenomedullin in patients with critical COVID-19 disease: new confirms from a prospective single centre cohort study  
I. Pia, E. Balzani, M. Perotto, A. Della Selva, E. Ravera, F. Pomerio, F. Rumbolo, G. Mengozzi, L. Brazzi, G. Montrucchio
- P 5** The role of Neutrophil-Reactive Intensity (NEUTRI) in ICU diagnosis of sepsis: a retrospective critical illness cohort study  
E.M.A. Mantovani, S. Pastori, V. Roccaforte, R. Panella, P. Formenti, M. Gotti, A. Pezzi, G. Sabbatini
- P 6** Importance of New Delhi Metallo-Beta-Lactamase Klebsiella pneumoniae surveillance in ICU: first case series in Northern Italy  
L. Rodigari, S. Zuccolin, G. Sales, S. Corcione, A. Curtoni, V. Fanelli, G. Montrucchio, L. Brazzi
- P 7** Spread of New Delhi-producing Klebsiella pneumoniae in liver transplant candidates: experience from an Italian border hospital  
G. Bacchetti, S. Andreutti, M. Lugano, D. Orso, S. Venturini, F. Cugini, T. Bove
- P 8** Candida auris identification in Piedmont, one year later: more colonizations than infections  
M. Cedrone, G. Torsello, S. Corcione, S. Nour, G. Sales, A. Curtoni, R. Cavallo, G. Montrucchio, L. Brazzi
- P 9** Propofol infusion and bloodstream infections incidence in the Intensive Care Unit. Preliminary results from an observational study  
A.M. Saponaro, G. Lupo, A. Gisotti, N. Tortora, F. Vurchio, N. Di Venosa
- P 10** Tailoring immunosuppressive therapy after liver transplantation: our center's experience  
G. Teri, C. Vullo, G. Bajlon, E.G.V. Porcile, A. Di Noto, M. Centanaro
- P 11** Conservative treated pleural empyema in liver transplant recipient for fulminant hepatitis: a case report  
S. Ronchi, S. Usai, G. Bajlon, I.Z. Iovino, M. Speranza, E.G.V. Porcile, M. Centanaro
- P 12** Toxic Epidermal Necrosis (TEN) in immunocompromised patients: a wound management case report  
M.R. Donatiello, S. Colombo, M. Macri, L. Fumagalli, A. Chiappella, K. Masala, G. Gobbi, F. Valenza, P. Corradini

## E-POSTER CORNER 2

Wednesday  
May 24

## DISCUSSION

h. 13.00 - 14.30

## COVID-19 2023

Chairpersons: G. De Pascale, V. Russotto

- P 13** The role of Neurally Adjusted Ventilator Assist (NAVA) in the management of Sars-CoV-2 related ARDS: an observational single-center study  
A. Lerosé, G. Morriello, P. Calligaro, S. Marchiotto, C. Cerrata, F. Vargiu, S. Bassanini, M. Carlini
- P 14** Lack of correlation between diaphragm thickening fraction and transdiaphragmatic pressure swing in COVID-19 pneumonia during helmet CPAP  
S. Lassola, S. Miori, A. Sanna, M. Umbrello, S. De Rosa, G. Bellani
- P 15** Acute coronary syndrome during COVID-19 pandemic: statistical analysis by an Operation Centre in Italy  
M. Paglialonga, M. Marchese, S. Colelli, G. Spagnoletti
- P 16** Mortality comparison between ICU patients with SARS-CoV2 infection during 2020-2022 in ICU: a retrospective study  
G. Renna, F. Giovenzana, A. Galic, D. Guarracino, L. De Ponti, A. Marino, F. Fabretti
- P 17** Clinical features and 28-day mortality predictors of vaccinated patients admitted to ICU with COVID-19  
C. Stella, C. Berardi, A. Chiarito, V. Gennenzi, S. Postorino, D. Settanni, M. Cesarano, R. Xhemalaj, E.S. Tanzarella, S.L. Cutuli, M. Antonelli, G. De Pascale
- P 18** Epidemiology, logistics and outcome of cardiogenic shock before and during COVID-19 pandemic: a matched cohort nationwide analysis - On behalf of GiViTi  
G. Tricella, C.N.J. Colombo, S. Finazzi, G. Tavazzi
- P 19** Immunological phenotypes of patients with severe COVID-19 infection and septic shock compared  
M. Tosi, E. Biagioni, E. Munari, I. Gatto, S. Busani, M. Girardis
- P 20** Extracellular vesicles from bone marrow (MSCEVs) and adipose (ASC-EVs) mesenchymal stem cells protect lung epithelial-endothelial barrier after challenge with plasma from severe COVID-19 ARDS patients  
A. Burello, M. Monfroglio, J. Kopecka, S. Scriveranti, A. Scagliotti, M.A.C. Pomatto, C. Gai, G. Sales, F. Collino, A. Costamagna, G. Montrucchio, P. Cappello, G. Castellano, V. Cantaluppi, C. Riganti, G. Camussi, V. Fanelli
- P 21** Impact of multidrug-resistant bacteria on bloodstream infections in critically ill ICU patients: comparison between a pre-pandemic (2016) and a COVID-19 cohort (2020-2021)  
G. Paolini, A. Vaninetti, E. Balzani, F. Grillo, V. Sanna, G. Sales, A. Costamagna, A. Curtoni, S. Corcione, G. Montrucchio, L. Brazzi
- P 22** Ventilation-associated pneumonia and multidrug-resistant microorganisms: a comparison between pre-COVID-19 and COVID-19 critical patients  
F. Grillo, E. Balzani, A. Vaninetti, G. Paolini, V. Sanna, G. Gavanna, G. Sales, A. Curtoni, S. Corcione, G. Montrucchio, L. Brazzi
- P 23** The incidence of pressure ulcers in COVID era patients: a retrospective observational study in a respiratory Intensive Care Unit  
K. Ferrari, M. Maurella, G. Orizio, F. Reitano, R. Fumagalli, M. Villa, A. Lucchini
- P 24** The experience of COVID-19 patients undergoing helmet CPAP  
L. Fumagalli, A. Carra, D. Magri, I. Mariconti, S. Napoli, G. Foti, M. Villa, A. Lucchini



## E-POSTER CORNER 1

Thursday  
May 25

## DISCUSSION

h. 13.00 - 14.30

## NEUROINTENSIVE CARE AND NEURO CASE REPORTS

Chairpersons: A. Giannini, C. Robba

- P 25** Care and caring: times and tools of connection in the critical care area. The diary  
C. Di Ruscio, B. Bigiarini, A. De Luca, L. Bucciardini, B. Meucci
- P 26** The role of Intensive Care Unit diaries in the grieving process: a monocentric qualitative study  
G. Bazzano, F. Buccoliero, L. Iannuzzi, M. Villa, A. Lucchini
- P 27** Caregiving and caring: times and tools of connection in Intensive Care Unit. The Caregiver's perspective  
L. Campagnola, B. Bigiarini, I. De Fanti, D. Becherelli, B. Meucci
- P 28** Natremia in traumatic brain injury patients in ICU. A sub-analysis in 1346 patients from CENTER-TBI  
F. Mulazzani, F. Graziano, P. Gilardi, E. Zanotto, L. Malgeri, M. Consonni, G. Pastore, B. Noè, C. Robba, G. Citerio
- P 29** Serum LDH levels may predict poor neurological outcome after aneurysmal subarachnoid hemorrhage  
I. Cavalli, C. Stella, L. Mascia, M. Salvagno, S. Schuind, F.S. Taccone, E. Gouvêa Bogossian
- P 30** Poor-grade aneurysmal subarachnoid haemorrhage in the elderly admitted to ICU - a single center retrospective study  
V. Piazza, L. Meletti, F. Graziano, P.V. Gilardi, F. Magni, M. Amigoni, L. Piergallini, M. Patassini, P. Remida, C.G. Giussani, G. Citerio
- P 31** Effects of acetazolamide on brain tissue oxygenation in ICU patients with acute brain injury  
C. Stella, A. Hachlouf, I. Cavalli, E. Gouvêa Bogossian, M. Anderloni, F.S. Taccone
- P 32** Spontaneous hyperventilation after traumatic brain injury: a case report  
G. Perini, C. Pacini, R. Antolini, F. Santoni, E. Vitali, A. Salvucci Salice, L. Pesaresi, A. Carsetti, A. Donati
- P 33** Early ventilation settings in brain-injured patients: an update from VENTIBRAIN Study  
C. Almondo, P. Pelosi, F. Graziano, F.S. Taccone, G. Citerio, C. Robba
- P 34** Spinal lesions prevalence in car crash among Lombardy Trauma Registry: what about self-extrication?  
F. Martignoni, R. Giudici, G. Zocchi, B. Franchi, A. Ongaro, E. Binda, M. Lattuada, M. Pappalardo, R. Pizzi, M. Stura, E. Borotto
- P 35** Anesthesia-induced Takotsubo cardiomyopathy in trigeminal neuralgia: illustrative case  
G. Mazzaglia, G. Bonomo, E. Rubio, P. Murabito, A. Amato, P. Ferroli, F.M. Cerbone, M. Gemma
- P 36** Eligibility prediction to awake craniotomy with a psychological tool: Besta 2022 experience  
A. Castelli, G. Mazzaglia, M. Cassa, M. Gemma

## E-POSTER CORNER 2

Thursday  
May 25

## DISCUSSION

h. 13.00 - 14.30

## ICU: HEART, KIDNEY, LUNG

Chairpersons: A. De Gasperi, S. Scolletta

- P 37** A whole body point-of-care ultrasound (POCUS) protocol reduces ICU mortality  
I. Corda, G. Cucciolini, F. Dazzi, F. Forfori, F. Corradi
- P 38** Time-course analyses of changes in End Expiratory Lung Volume measured with Electrical Impedance Tomography  
I. Fratti, G. Hahn, T. Pozzi, A. Fioccola, R. D'Albo, M. Velati, R.V. Nicolardi, F. Lombardo, S. Gattarello, M. Busana, O. Moerer, F. Romitti, L. Gattinoni
- P 39** Gas volumes corrections in ICU: needed or pointless?  
R. D'Albo, F. Romitti, A. Fioccola, T. Pozzi, I. Fratti, M. Velati, R.V. Nicolardi, F. Lombardo, M. Busana, O. Moerer, L. Camporota, L. Gattinoni
- P 40** Sodium and chloride sieving coefficient during continuous venovenous hemofiltration (CVVH) in the critically ill patients  
F. Zadek, F. Mulazzani, B. Brunoni, A. Altomare, F. Minotti, M. Laratta, T. Langer, R. Fumagalli
- P 41** Sodium variations during continuous veno-venous hemofiltration: a mathematical model and in-vitro study  
F. Mulazzani, F. Zadek, B. Brunoni, G. Verza, A. Bonaiti, S. Ubiali, G. Esposito, I. Giovannini, T. Langer, R. Fumagalli
- P 42** Monitoring and safe use of regional citrate anticoagulation for renal replacement therapy in patients with metformin intoxication: a case series and mathematical model  
B. Brunoni, F. Zadek, F. Mulazzani, R. Castelli, L. Faraldi, A. Rossi, A. Protti, R. Fumagalli, T. Langer
- P 43** Cardiogenic shock in general Intensive Care Unit: a nationwide prospective analysis of epidemiology and outcome - On behalf of GiViTI  
G. Tavazzi, G. Tricella, C.N.J. Colombo, E. Garbero, A. Zamperoni, M. Zanetti, S. Finazzi
- P 44** Non-ischemic cardiogenic shock: relationship between inotropes, vasopressors and mortality in a monocentric retrospective study  
M. Erba, C.N.J. Colombo, L. Battistini, C. Bianciardi, E. Fiocco, F. Rossi, N. Labella, M. Caria, F. Mojoli, G. Tavazzi
- P 45** Early VA-ECMO support for cardiogenic shock in sepsis-induced cardiomyopathy due to pneumococcal pneumonia: a case report  
V. Aleksandrov, V. Salice, D.T. Andreis, E. Gallazzi, V.C. Porta, L. Bogno, M. Lucchelli, G. Mistraretti
- P 46** Physiopathological based approach for mechanical circulatory support titration  
L. Patrini, C.N.J. Colombo, F. Rossi, M. Erba, F. Mojoli, C. Pellegrini, G. Tavazzi
- P 47** Hemodynamic and clinical predictors of successful weaning from VA-ECMO  
C.N.J. Colombo, M. Voltini, G. Mazza, V. Dammasa, F. Cantarella, L. Patrini, M. Caria, R. Camporotondo, F. Mojoli, C. Pellegrini, G. Tavazzi
- P 48** Development of a smartphone application to support the management and activation of an intrahospital emergency facility  
M. Bixio, C. Spina, M. Centanaro

## E-POSTER CORNER 1

Friday  
May 26

## DISCUSSION

h. 13.00 - 14.30

## ANESTHESIA

Chairpersons: R.M. Corso, A. De Gasperi

- P 49** Auricular acupuncture for controlled hypotension in FESS: a case series  
M. Pallocchi, F. Sbaraglia, C. Riso, D. Del Prete, G. Spinazzola, D. Micci, F. Antonicelli, A. Scarano, M. Del Vicario, M. Rossi
- P 50** Perioperative intravenous (i.v.) lidocaine in laparoscopic bariatric surgery (LBS) improves quality of recovery: an observational retrospective study  
C. Gobbi, E. Campane, L. Botta, M. Aspesi, M. Faluomi, F. Maretti, S. Passera, S. Patanè, E. Serafinelli, A. Rizzi, S. Del Ferraro, F. Lazzarin, P. Severgnini
- P 51** The importance of treatment with perioperative CPAP in patients with OSA/OHS candidate to bariatric surgery  
E. Campane, C. Gobbi, L. Botta, M. Aspesi, M. Faluomi, A. Ambrosini, E.M. Boracchi, C. Corliano, C. Fachinetti, A. Rizzi, L. Broggi, S. Gianazza, P. Severgnini
- P 52** Watch out for the weight and watch in with the video. Videolaryngoscopy as clinical risk mitigator in obese patient  
L. Brugiaferri, M. Ciuffreda, E. Pisello, S. Sorrenti, J. Silvestri, C. Chinigioli, D. Galante, C. Piangatelli
- P 53** Don't worry, there's videolaryngo!  
C. Chinigioli, V. Biscaccianti, M. Ciuffreda, E. Pisello, J. Silvestri, L. Brugiaferri, S. Sorrenti, C. Piangatelli, D. Galante
- P 54** A novel and safe method for oral awake endotracheal intubation  
C. Zhang, M. Pirrone
- P 55** Opioid-sparing analgesia in proximal femur fracture in elderly: a dose finding study  
A. Eminente, G. Pilerici
- P 56** Amplatzer atrial septal occluder migration into the left ventricular: an emergent surgery  
E. Montrasio, L. Saia, F. Maolo, S. Marianeschi, M. Mondino
- P 57** Opioid-sparing anesthesia and Charcot-Marie-Tooth disease: a case report  
N. Mongiovi, A. Vignali, G. Bertoni, M. Guadagnucci, G. Mosti, A. Baratta
- P 58** Anesthesia management for left cardiac sympathetic denervation in children with congenital long QT syndrome and catecholaminergic polymorphic ventricular tachycardia  
M. Cavagnino, V. Mossetti, G. Maiolo, H. Haxhi Nasto, R. Di Corrado, A. Conio, S. Quaglia
- P 59** "Crack lung" ALI/ARDS: a case of complex weaning after general anesthesia for minor surgery  
S. Tantillo, M. Guarnera, F. Talarico, L. Giuntoli, I. Farinelli, C. Della Casa, E. Panigas, F. Moro, V. Rizzelli, F. Benvenuti, A. Lacerenza, N. Cilloni

## E-POSTER CORNER 2

Friday  
May 26

## DISCUSSION

h. 13.00 - 14.30

## CASE REPORTS

Chairpersons: S. Grasso, A. Siniscalchi

- P 60** Air transport of pediatric pneumomediastinum  
F. Bernasconi, M. Teruzzi, F. Sangalli, M. Alber, P. Nazzari, G. Senini, M. Merolla, A. Cadisco, D. Comi, A. Giupponi, G. Marconi
- P 61** Achalasia masquerading as status asthmaticus  
E. Ruivo, J. Nunes, J. Oliveira, G. Henriques, L. Melão, D. Nunez, P. Perez, J. Moreno, S. Castro
- P 62** Refractory hypercapnia in asthma exacerbation. Utility of extra-corporeal carbon dioxide removal (ECCO<sub>2</sub>R) to facilitate respiratory weaning: a case report  
C. Pugno, M. Murrone, A. Marino, F. Fabretti
- P 63** Acute aortic insufficiency after chest blunt trauma: two cases report  
G. Carenini, C. Forlini, I. Giovannini, M. Laratta, E. Zago, P. Previtali, L. Faraldi, R. Giudici, R. Fumagalli
- P 64** V-V ECMO: a rescue therapy for a patient with severe tracheal stenosis due to thoracic aorta aneurysm  
M. Giacosa, F. Grandini, G. Maggio, S. Mongodi, G. Tavazzi, F. Mojoli
- P 65** Acute respiratory failure caused by pulmonary, pericardium and mediastinum infection due to esophageal fistula subsequent a chicken bone ingestion: V-V ECMO as rescue therapy  
F. Grandini, L. Civardi, S. Mongodi, F. Capra Marzani, G. Tavazzi, M. Pagani, F. Mojoli
- P 66** Massive CRS after Car-T cell therapy in high-grade B cell lymphoma  
S. Rossi, A. Bellucci, G. Bajlon, G. Zucco, M. Pastorino, E.G.V. Porcile, M. Centanaro
- P 67** Hybrid Ciaglia percutaneous tracheostomy with surgical assistance in patient undergoing continuous heparin infusion  
R. Antolini, E. Vitali, G. Perini, C. Pacini, F. Santoni, A. Salvucci Salice, L. Pesaresi, A. Carsetti, A. Donati
- P 68** CytoSorb in severe malaria infection: useful or harmful? A case report  
A. Volontè, C. Di Martino, L. Fagnani, I. Riva, A. Marino, F. Fabretti
- P 69** Sequential application of CytoSorb and Therapeutic Plasma Exchange in septic shock: a case report  
A. Volontè, S. Lo Coco, A. Marino, I. Riva, F. Fabretti
- P 70** Late treatment of calcium channel blocker intoxication with Hyperinsulinemia/Euglycemic Therapy (HIET): a case report  
F. Buono, V. Broletti, I. Piazza, D. Filippi, A. Marino, F. Fabretti
- P 71** Acute perchloroethylene intoxication in an elderly woman: a case report  
A. Tarditi, L. Montalbano, S. Spina, F. Marrasso, G. Casella, P. Schenardi, T. Conti, I. Angeli, M. Minoli, R. Fumagalli, T. Langer

# EDUCATIONAL COURSES

## Faculty

**Aloisio T.**, Milano (I)  
**Andreotti A.**, Modena (I)  
**Antonelli M.**, Roma (I)  
**Bambi S.**, Firenze (I)  
**Bertini P.**, Pisa (I)  
**Bonfiglio R.**, Genova (I)  
**Bulleri E.**, Lugano (CH)  
**Caironi P.**, Torino (I)  
**Cislaghi F.**, Milano  
**Colombo D.**, Milano (I)  
**Conti G.**, Roma (I)  
**Cortese G.**, Torino (I)  
**Foti G.**, Monza (I)  
**Fusi C.**, Lugano (CH)  
**Galazzi A.**, Milano (I)  
**Gattinoni L.**, Goettingen (D)  
**Giani M.**, Monza (I)  
**Gregoretti C.**, Palermo (I)  
**Greif R.**, Bern (CH)  
**Iapichino G.**, Milano (I)  
**Iotti G.A.**, Pavia (I)  
**Langer T.**, Milano (I)  
**Lucchini A.**, Monza (I)  
**Minotti D.**, Monza (I)  
**Navalesi P.**, Padova (I)  
**Nava S.**, Bologna (I)  
**Radrizzani D.**, Legnano - Milano (I)  
**Ranieri V.M.**, Bologna (I)  
**Reviriego L.**, Valencia (E)  
**Rubino A.**, Cambridge (UK)  
**Russotto V.**, Torino (I)  
**Sanfilippo F.**, Catania (I)  
**Sangalli F.**, Sondrio (I)  
**Tavazzi G.**, Pavia (I)  
**Zadek F.**, Milano (I)  
**Zanello M.**, Bologna (I)

- Corso Teorico-Pratico VAM 2023  
I FONDAMENTALI DELLA VENTILAZIONE MECCANICA  
22-23 MAGGIO 2023
- Corso Teorico-Pratico  
ITACTA BEsT - CERTIFICAZIONE IN  
ECOCARDIOGRAFIA TRANSESOFOGEEA BASIC  
22-23 MAGGIO 2023
- Interactive Theoretical-Practical Course  
ACID-BASE EQUILIBRIUM:  
TO REMEMBER YOU NEED TO UNDERSTAND...  
MAY 23, 2023
- Corso Teorico-Pratico  
EAMS - TEACH THE AIRWAY TEACHER (TAT)  
23 MAGGIO 2023
- Corso  
COME TRATTARE IL PAZIENTE MALNUTRITO/  
CATABOLICO: UNA QUESTIONE MISCONOSCIUTA  
DI SOPRAVVIVENZA  
24 MAGGIO 2023
- Corso Teorico-Pratico Nursing  
UPDATE VENTILAZIONE MECCANICA PER INFERMIERI  
25 MAGGIO 2023

Language: English or Italian, no simultaneous translation.  
Lingua: Inglese o Italiano, senza traduzione simultanea.

## EDUCATIONAL COURSES

MAY 22-23

Corso Teorico-Pratico VAM 2023

## I FONDAMENTALI DELLA VENTILAZIONE MECCANICA

Direttore del Corso: **P. Navalesi** | Numero chiuso, max 80 partecipanti

## AMBER HALL 3-4

Lunedì 22 Maggio	Martedì 23 Maggio
8.30 <b>Registrazione dei Partecipanti</b>	8.30 <b>La ventilazione non invasiva</b> <ul style="list-style-type: none"> <li>I ventilatori, i circuiti, le interfacce - C. Gregoretti</li> <li>Le indicazioni - M. Antonelli</li> </ul>
8.45 <b>Pump failure e lung failure: cause di insufficienza respiratoria acuta</b> <ul style="list-style-type: none"> <li>Polmone - M. Antonelli</li> <li>Vie aeree - S. Nava</li> <li>Cuore - G. Foti</li> <li>Sistema nervoso e muscoli - P. Navalesi</li> </ul>	10.00 <b>Lavorare sul polmone malato con le pressioni: caso clinico (ventilazione protettiva, PEEP, curva pressione-volume e reclutamento)</b> G. Foti, C. Gregoretti
10.15 COFFEE BREAK	11.00 COFFEE BREAK
10.45 <b>Supporto ventilatorio totale: modalità controllate</b> <ul style="list-style-type: none"> <li>Volume - G.A. Iotti</li> <li>Pressione - C. Gregoretti</li> </ul>	11.30 <b>Supporto ventilatorio totale: modalità controllate</b> <ul style="list-style-type: none"> <li>ARDS e VILI - V.M. Ranieri</li> </ul>
11.30 <b>Il circuito del ventilatore</b> <ul style="list-style-type: none"> <li>Umidificazione - G. Conti</li> <li>Nebulizzazione - G. A. Iotti</li> </ul>	12.00 <b>Come ventilo il paziente ostruttivo: caso clinico di stato di male asmatico</b> M. Antonelli, G. Conti, S. Nava, P. Navalesi
12.00 <b>Supporto ventilatorio parziale: modalità assistite</b> <ul style="list-style-type: none"> <li>L'approccio USA: l'Assistita-Controllata - G.A. Iotti</li> <li>L'approccio Europeo: il Pressure Support - G. Conti</li> </ul>	12.45 <b>Riduzione del carico ventilatorio: ruolo della LF-ECCO2-R</b> - V.M. Ranieri
13.00 SNACK LUNCH	13.05 SNACK LUNCH
14.00 <b>Supporto ventilatorio parziale: altre modalità assistite</b> <ul style="list-style-type: none"> <li>Intermittent Mandatory Ventilation (IMV) - G.A. Iotti</li> <li>Bilevel / Airway Pressure Release Ventilation (APRV) - G. Foti</li> </ul>	14.00 <b>Il weaning</b> - S. Nava
14.40 <b>Valutazione della meccanica respiratoria passiva</b> <ul style="list-style-type: none"> <li>Resistenza e AutoPEEP - G.A. Iotti</li> <li>Compliance - G. Foti</li> </ul>	14.30 <b>L'estubazione</b> - P. Navalesi
15.30 <b>INCONTRO CON GLI ESPERTI</b> <b>Esercitazioni pratiche a rotazione</b> Parte 1 - 4 Workstation - Tutti i docenti	15.00 <b>INCONTRO CON GLI ESPERTI</b> <b>Esercitazioni pratiche a rotazione</b> Parte 2 - 4 Workstation - Tutti i docenti
18.00 <b>Chiusura della giornata</b>	17.00 <b>Chiusura del Corso</b>

**ESERCITAZIONI PRATICHE.** I partecipanti saranno suddivisi in gruppi di lavoro. Ciascun gruppo, guidato dagli esperti, ruoterà su workstation con tappe di 30 minuti ciascuna nei due pomeriggi.

## EDUCATIONAL COURSES

MAY 22-23

Corso Teorico-Pratico

## ITACTA BeSt - CERTIFICAZIONE IN ECOCARDIOGRAFIA TRANSESOFOGEEA BASIC

Direttori del Corso: **P. Bertini, A. Rubino, F. Sangalli** | Numero chiuso, max 30 partecipantiSpeakers: **T. Aloisio, F. Cislighi, F. Sanfilippo, G. Tavazzi**

## BROWN HALL 1

Lunedì 22 Maggio	Martedì 23 Maggio
8.30 <b>Registrazione dei Partecipanti</b>	<b>APPLICAZIONI TEE NEL PAZIENTE CRITICO (CASE-BASED LEARNING)</b>
<b>BASI DI ECOCARDIOGRAFIA TRANSESOFOGEEA</b>	9.00 <b>Warm-up: casi clinici</b> sulle presentazioni del primo giorno
9.00 <b>Presentazione del Corso</b> A. Rubino, F. Sangalli	9.30 <b>Valvulopatie: le basi</b>
9.15 <b>Fisica degli ultrasuoni, impostazioni dell'ecografo, artefatti</b>	10.00 <b>Sindromi aortiche acute</b>
09.45 <b>L'esame BEsT: anatomia e proiezioni</b>	10.30 COFFEE BREAK
10.30 COFFEE BREAK	10.45 <b>HANDS-ON</b> <b>Esercitazioni pratiche su simulatore e discussione di casi clinici</b>
10.45 <b>HANDS-ON</b> <b>Esercitazioni pratiche su simulatore e discussione di casi clinici</b>	13.00 PAUSA PRANZO
13.00 PAUSA PRANZO	14.00 <b>Arresto cardiaco ed E-CPR</b>
14.00 <b>Il ventricolo sinistro: funzione sistolica e diastolica</b>	14.30 <b>Valutazione ecodinamica quotidiana nel paziente critico</b>
14.30 <b>Il ventricolo destro: funzione sistolica e diastolica</b>	15.00 <b>TEE nell'ipertensione polmonare acuta e cronica</b>
15.00 <b>Calcoli emodinamici e valutazione della volemia</b>	15.30 BREAK
15.30 BREAK	15.45 <b>HANDS-ON</b> <b>Esercitazioni pratiche su simulatore e discussione di casi clinici</b>
15.45 <b>HANDS-ON</b> <b>Esercitazioni pratiche su simulatore e discussione di casi clinici</b>	17.15 <b>Valutazione finale</b>
18.00 <b>Chiusura della giornata</b>	18.00 <b>Chiusura del Corso</b>

**ESERCITAZIONI PRATICHE.** Nelle sessioni Hands-on i partecipanti saranno suddivisi in due gruppi che si alterneranno tra discussione interattiva di casi clinici e attività pratica su simulatore.

Il programma ITACTA BeSt rappresenta una **CERTIFICAZIONE DI COMPETENZA IN ECOCARDIOGRAFIA TRANSESOFOGEEA BASIC** e si articola in quattro momenti: Corso teorico-pratico | Valutazione teorico-pratica | Percorso di tutorato per l'esecuzione di esami BEsT normali e patologici con compilazione di un logbook e revisione di clip | Conferimento della Certificazione di Competenza  
Maggiori dettagli sono disponibili al sito [www.itacta.org/itacta-best/](http://www.itacta.org/itacta-best/)

Con il contributo non condizionante di: **Accurate**  
Learn. Practice. Improve.

## EDUCATIONAL COURSES

MAY 23

Interactive Theoretical-Practical Course

**ACID-BASE EQUILIBRIUM: TO REMEMBER YOU NEED TO UNDERSTAND...**Course Director: **L. Gattinoni** | Max 80 participants

## AMBER HALL 5

Tuesday, May 23

8.30	<b>Registration</b>	14.15	<b>Metabolic acidosis: diagnosis and treatment with alkalinizing agents</b> <i>P. Caironi</i>
8.40	<b>Opening greetings and presentation of the Course</b> <i>L. Gattinoni</i>	14.35	<b>Metabolic alkalosis: what produces and what maintains it</b> <i>T. Langer</i>
8.55	<b>Warm-up case</b> <i>F. Zadek</i>	14.55	<b>Respiratory acidosis: when and how to correct it</b> <i>L. Gattinoni</i>
9.05	<b>Gas exchange. Overall evaluation of oxygen and CO<sub>2</sub>: similarities and differences</b> <i>L. Gattinoni</i>	15.15	<b>Boston rules revisited</b> <i>F. Zadek</i>
9.40	<b>Physicochemical approach to acid-base equilibrium: advantages and limitations</b> <i>P. Caironi</i>	15.35	<b>Acid-base alterations induced by intravenous fluid therapy</b> <i>P. Caironi</i>
10.10	<b>Classic approach to acid-base equilibrium: what does the Henderson-Hasselbalch really mean?</b> <i>L. Gattinoni</i>	15.55	BREAK
10.40	<b>How does the blood gas analyzer work? Pre-analytical errors and meaning of the measured/calculated variables</b> <i>T. Langer</i>	16.15	<b>Cerebrospinal fluid acid-base equilibrium</b> <i>F. Zadek</i>
11.10	<b>Technological evolution in blood gas analysis</b> <i>D. Colombo</i>	16.35	<b>Diuretics and acid-base</b> <i>P. Caironi</i>
11.30	COFFEE BREAK	16.55	<b>INTERACTIVE CLINICAL CASES - Part 2</b> <i>T. Langer, F. Zadek, P. Caironi, L. Gattinoni</i>
11.45	<b>A single reading key for respiration and circulation: the arterio-venous blood gas analysis</b> <i>L. Gattinoni</i>	17.55	<b>Closing remarks</b> <i>L. Gattinoni</i>
12.05	<b>Base Excess: clinical use and limitations</b> <i>T. Langer</i>		
12.25	<b>INTERACTIVE CLINICAL CASES - Part 1</b> <i>T. Langer, F. Zadek, P. Caironi, L. Gattinoni</i>		
13.25	LUNCH BREAK		

The Course includes an interactive discussion of clinical scenarios with voting. Interactive voting is possible through the app **Poll Everywhere** (<https://www.polleverywhere.com/mobile>) or by linking at <https://pollev.com/thomaslanger673>

Unrestricted grant of **werfen**

## EDUCATIONAL COURSES

MAY 23

Corso Teorico-Pratico

**EAMS - TEACH THE AIRWAY TEACHER (TAT)**Direttore del Corso: **G. Cortese** | Numero chiuso, max 16 partecipanti

## BROWN HALL 2

Martedì 23 Maggio

8.45	<b>Registrazione dei Partecipanti</b>	14.00	<b>Sessione 4. Introduzione al debriefing clinico - TALK</b> <i>Workshop a piccoli gruppi</i>
9.00	<b>Welcome TAT. Sociogramma, aspettative dei partecipanti e obiettivi formativi</b> <i>Sessione plenaria</i>	15.30	BREAK
9.30	<b>Sessione 1. Come organizzare un corso di gestione delle vie aeree (VA)?</b> <i>Workshop a piccoli gruppi</i>	15.45	<b>Sessione 5. Micro-insegnamento simulato sulla gestione delle VA</b> <i>Workshop a piccoli gruppi</i>
10.30	COFFEE BREAK	17.15	<b>Sessione finale. Feedback e debriefing sul Corso</b> <i>Sessione plenaria</i>
10.45	<b>Sessione 2. Fishbowl - Discussione sulle domande pre-corso</b> <b>1. Quali competenze bisogna avere per insegnare la gestione delle VA?</b> <b>2. Come trasmettere le competenze necessarie per la gestione delle VA?</b> <b>3. Come insegnare i fattori umani (competenze non tecniche) nella gestione delle VA?</b> <i>Sessione plenaria</i>	17.30	Chiusura del Corso
11.45	<b>Sessione 3. Debriefing sui video delle lezioni dei partecipanti</b> <i>Workshop a piccoli gruppi</i>		
13.00	PAUSA PRANZO		

## FACULTY

A. Andreotti, Modena (I)  
G. Cortese, Torino (I)  
R. Greif, Bern (CH)

## TUTOR

R. Bonfiglio, Genova (I)  
L. Reviriego, Valencia (E)

La Gestione delle Vie Aeree è una competenza cruciale in anestesia, terapia intensiva e medicina d'urgenza. È fondamentale che i docenti di gestione delle vie aeree siano specificamente formati sul "come e cosa" insegnare, ma a oggi mancano programmi e requisiti standardizzati in questo ambito. Il Corso **Teach the Airway Teacher (TAT) di European Airway Management Society (EAMS)** nasce con l'obiettivo di fornire le competenze didattiche ai docenti che si occupano di insegnamento delle skill tecniche e non tecniche inerenti la Gestione delle Vie Aeree. Il Corso si svolge in modalità "ibrida", con una fase pre-corso (video di e-learning sui diversi "core-topics" relativi all'insegnamento), una fase "on-site" (sessioni simulate e workshops) ed una applicazione pratica post-corso, da svolgere nella propria realtà didattica. Al termine di questo percorso il discente riceverà la certificazione europea ufficiale di **EAMS - Airway Teacher**.

L'iscrizione al Corso TAT comprende la quota associativa annuale EAMS.

L'iscrizione al Corso TAT è possibile esclusivamente dal portale **www.airwaymanagementacademy.com** attraverso il link **https://www.eamshq.net/education/teach-the-airway-teacher**

## EDUCATIONAL COURSES

MAY 24

Corso

**COME TRATTARE IL PAZIENTE MALNUTRITO/CATABOLICO:  
UNA QUESTIONE MISCONOSCIUTA DI SOPRAVVIVENZA**Board Scientifico: **G. Iapichino, D. Radrizzani, M. Zanella** | Numero chiuso, max 60 partecipanti**SUITE 3**

Mercoledì 24 Maggio | 9.00 - 13.30

8.30 Registrazione dei Partecipanti

9.00 Il Corso affronterà le seguenti tematiche in **sessione interattiva\*** con i partecipanti:

- quali sono i principali disordini metabolici di un paziente malnutrito/catabolico;
- fisiopatologia sottostante al quadro clinico;
- come un trattamento inappropriato può portare al decesso del paziente;
- quale è l'approccio corretto alle problematiche legate a malnutrizione /catabolismo.

13.30 Chiusura del Corso

\* **Sessione interattiva:** le tematiche verranno affrontate presentando e discutendo scenari, problematiche, dubbi e quesiti che i partecipanti si sono trovati ad affrontare nella pratica clinica e che desiderino condividere. A questo scopo, se ne richiede l'invio a: [iapicobis@gmail.com](mailto:iapicobis@gmail.com) e/o a [smart@startpromotion.it](mailto:smart@startpromotion.it) (con una descrizione minima dello scenario o problematica) almeno 30 giorni prima dell'inizio del Corso, per una opportuna preparazione per la discussione.

## EDUCATIONAL COURSES

MAY 25

Corso Teorico-Pratico Nursing

**UPDATE VENTILAZIONE MECCANICA PER INFERMIERI**Direttore del Corso: **A. Lucchini** | Numero chiuso, max 35 partecipanti**SUITE HALL 5-6** | Piano Mezzanino

Giovedì 25 Maggio

8.30 Registrazione dei Partecipanti

9.00 Introduzione e presentazione del Corso

9.15 Start test interattivo

9.30 **Concetti chiave di ventilazione meccanica**  
*E. Bulleri*10.15 **Intubazione del paziente critico**  
*V. Russotto*10.40 **Quando pensare all'ECMO**  
*M. Giani*11.00 **High Flow Nasal Cannula**  
*A. Galazzi*11.30 **Helmet CPAP**  
*A. Lucchini*12.00 **NIV PSV**  
*S. Bambi*

12.30 PAUSA PRANZO

14.30 **IN TERAPIA INTENSIVA****Monitoraggio grafico durante ventilazione controllata**  
*C. Fusi*15.15 **Awake and standard prone position**  
*D. Minotti*15.30 **Umidificatori, filtri ed aerosol**  
*A. Lucchini*16.00 **HANDS-ON**  
**Helmet CPAP, PSV NIV, ventilazione meccanica, aerosol terapia**  
*Tutti i docenti*17.30 **Chiusura del Corso****ESERCITAZIONI PRATICHE.**

Nelle sessioni HANDS ON i partecipanti, suddivisi in gruppi di lavoro, ruoteranno su 4 workstation.

# GENERAL INFORMATION

---

## GENERAL INFORMATION

### MEETING VENUE

Allianz MiCo - South Wing | Level 1 and Level 2



**GATE 2** Entrance: Viale Eginardo

**GATE 16** Entrance: Via Gattamelata

20149 Milano

Website: [www.micomilano.it](http://www.micomilano.it)



### ORGANIZING SECRETARIAT

#### Start Promotion Srl

Via Mauro Macchi, 50 - 20124 Milano - Italy

Tel. +39 02 67071383 | Fax +39 02 67072294

Email: [info@startpromotion.it](mailto:info@startpromotion.it) | [www.startpromotion.it](http://www.startpromotion.it)

### ON-SITE SECRETARIAT

The SMART Secretariat will be available on-site (Level 1 and Level 2 of the Allianz MiCo - South Wing), from 7.30 a.m. of Wednesday May 24 to the closing of the scientific sessions, according to the following opening hours:

Wednesday	May 24	7.30 - 18.30
Thursday	May 25	8.00 - 18.30
Friday	May 26	8.00 - 18.00

#### LEVEL 1

- Cloakroom
- Pre-registered Residents & Students
- New registrations Residents & Students
- Pre-registered Visitors
- New registrations Visitors

#### LEVEL 2

- Pre-registered Physicians & Nurses
- New registrations Physicians & Nurses
- Faculty
- Sponsoring Companies
- Info Point

### OFFICIAL LANGUAGES

#### SMART MEETING

English, no simultaneous translation.

#### WeSMART SESSIONS

English or Italian, no simultaneous translation.

#### SIMULATION SESSIONS

English or Italian, no simultaneous translation.

#### MEET THE EXPERT SESSIONS

English or Italian, no simultaneous translation.

#### ORAL PRESENTATIONS AND POSTERS

English, no simultaneous translation.

#### EDUCATIONAL COURSES

English or Italian, no simultaneous translation.

#### SMART NURSING

Italian, no simultaneous translation.

### FACULTY LOUNGE

A Faculty Lounge with internet point, exclusively reserved for speakers and chairpersons, is available in the Scientific Area (see layout 3).

### COFFEE POINTS

Coffee Points are located in the Exhibition Area (see Catering Areas on layout 1).

### BUFFET SERVICE

A buffet service (see layout 3) is open from h 12.30 to h 15.00.  
*Hors d'oeuvre - First Course - Second Course - Vegetables*  
*Dessert - Coffee - Water and Wine - € 37.00*

A Cafeteria is available in the Scientific Area (see layout 3). You can also find several restaurants and snack bars in the surroundings of the meeting venue.

### PRESS REGISTRATION

Accredited members of the press are welcome to the SMART Meeting.

### EXHIBITION

A wide Exhibition is available to participants. Exhibitors will be glad to introduce you the latest medical technologies and pharmaceutical products. We suggest you to visit this interesting area.

### SCIENTIFIC INFORMATION

#### ORAL PRESENTATIONS

Oral presentations are scheduled on May 24-25-26 at different sessions as specified in the program. To each presentation a total time of 12 minutes is assigned, including 4 minutes for discussion.

#### E-POSTER SESSIONS

All posters presented at the 34<sup>th</sup> SMART Meeting are displayed as E-posters on touchscreen monitors located in the E-Poster Corners (see layout 1) from h 9.00 of Wednesday May 24 to h 17.00 of Friday May 26.

Poster discussion will take place in the E-Poster Corners (see layout 1) as detailed below:

#### WEDNESDAY MAY 24, H 13.00 - 14.30

- BIOMARKERS AND INFECTIONS  
(E-Poster Corner 1)
- COVID-19 2023  
(E-Poster Corner 2)

#### THURSDAY MAY 25, H 13.00 - 14.30

- NEUROINTENSIVE CARE AND NEURO CASE REPORTS  
(E-Poster Corner 1)
- ICU:HEART, KIDNEY, LUNG  
(E-Poster Corner 2)

#### FRIDAY MAY 26, H 13.00 - 14.30

- ANESTHESIA  
(E-Poster Corner 1)
- CASE REPORTS  
(E-Poster Corner 2)

At least one of the Authors is requested to be in the E-Poster Corner to interact with the audience. All accepted abstracts will be published on [www.smartonweb.org](http://www.smartonweb.org).

### Best Abstract Award

During the 34<sup>th</sup> SMART the best three abstracts presented at the meeting will be awarded. All participants who present an abstract at the meeting, either as oral presentation or poster, are automatically eligible for the award. Selections will be based on the following two main criteria: quality and scientific relevance, originality of the research.

Award winners will be informed by email and formally invited to attend the Award Ceremony that will take place on **Thursday May 25 at h. 18.00 in the Exhibition Area**.

**In order to receive the award, winners are requested to be registered to the SMART Meeting and must be present at the Award Ceremony.**

*All prizes are dedicated to Dr. Mario Veronesi and kindly offered by INTERSURGICAL.*

#### PRIZES

**1<sup>st</sup> PRIZE:** Award Certificate, 1 registration voucher for the next SMART Meeting, monetary award of € 1000.00

**2<sup>nd</sup> PRIZE:** Award Certificate, 1 registration voucher for the next SMART Meeting, monetary award of € 500.00

**3<sup>rd</sup> PRIZE:** Award Certificate, 1 registration voucher for the next SMART Meeting, monetary award of € 300.00



## GENERAL INFORMATION

## REGISTRATION FEES

	BEFORE MARCH 30	AFTER MARCH 30	ON-SITE
<b>Physicians</b> ESICM Members	€ 296.00	€ 352.00	€ 392.00
<b>Physicians</b> SIAARTI, AAROI, ESPNIC Members	€ 320.00	€ 390.00	€ 420.00
<b>Physicians</b> Non Members	€ 370.00	€ 440.00	€ 490.00
<b>Physicians</b> from low and middle-income countries §	€ 220.00	€ 270.00	€ 300.00
<b>Veterinarians</b>	€ 200.00	€ 220.00	€ 250.00
<b>Nurses</b> *	€ 130.00	€ 160.00	€ 180.00
<b>Visitors #</b>	€ 122.00	€ 122.00	€ 122.00
<b>Residents/Students**</b>	Free entrance (with mandatory pre-registration)		

Legal VAT is included

§ Low and middle-income countries <https://data.worldbank.org/country/XO>

\* Pre-registration should be submitted online at [www.smartonweb.org](http://www.smartonweb.org) or [www.startpromotion.it](http://www.startpromotion.it). During the pre-registration procedure, Nurses will be required to upload a document proving their status. The congress bag is guaranteed only to pre-registered participants.

# Registration for Visitors is mandatory. The Visitor Badge gives access to all SMART areas/spaces except for Scientific Halls and Simulation Center.

\*\* Pre-registration should be submitted online at [www.smartonweb.org](http://www.smartonweb.org) or [www.startpromotion.it](http://www.startpromotion.it). During the pre-registration procedure, Residents/Students will be required to upload a document proving their status. Free admittance does not entitle to the congress kit.

Online pre-registrations should be submitted before **May 10, 2023**. Later registrations are possible on-site only.

Registration fees include: congress bag, badge, attendance certificate and any catering services included in the program.

The congress bag is guaranteed only to pre-registered participants (Physicians & Nurses).

## ONLINE REGISTRATION

Both registration (SMART Meeting, Educational Courses) and hotel reservation should be submitted online at the websites [www.smartonweb.org](http://www.smartonweb.org) and/or [www.startpromotion.it](http://www.startpromotion.it). Please read the instructions carefully before starting your registration/reservation.

## INSTRUCTIONS FOR PAYMENT

Payment of the registration fees can be made as follows:

- **Bank transfer** (free of charge for the beneficiary)  
To: START PROMOTION S.r.l.  
Bank: Banca Intesa San Paolo Spa  
IBAN: IT21X0306911310000027269163  
SWIFT/BIC CODE: BCITITMM  
As payment description please enter: **SMART 2023, first & family name of the Registrant**. If payment includes also an Educational Course and/or a hotel reservation, please specify the Course title and/or the name of the hotel.
- **Credit Card** (Visa, Mastercard, Maestro, Moneta)

## CANCELLATION POLICY

A 50% refund of the registration fee will be paid ONLY for cancellations notified in writing before **April 14, 2023**. No refund is due for later cancellations

## INVOICING

The invoice will be sent to the address entered during registration at [www.smartonweb.org](http://www.smartonweb.org) and/or [www.startpromotion.it](http://www.startpromotion.it).  
Receipt of the invoice will confirm registration.

## SIMULATION SESSIONS

Admission to the Simulation Sessions is limited to 40 participants, with mandatory pre-registration. Registrations will be accepted on a first-come first-served basis, depending on availability.

SIMULATION SESSIONS	FEE
Intubazione video-guidata, una nuova metodica dall'anestesia generale all'awake	€ 30.00
Dall'ottimizzazione del pressure support alla ventilazione proporzionale: ...	€ 30.00
Strategia per una sedazione sicura	€ 30.00
eCPR cheat sheet: a simulation scenario	€ 30.00
Insights into the ECMO Hub & Spoke model: logistical, clinical and technical challenges	€ 30.00
Reclutamento alveolare e impostazione della PEEP in base alla meccanica respiratoria	€ 30.00
Fluid responsiveness e sua valutazione attraverso il monitoraggio emodinamico ...	€ 30.00
Nuovi approcci nella ventilazione meccanica	€ 30.00

Current Italian VAT is included

## HIGH FIDELITY SIMULATION SESSIONS

Admission to the High Fidelity Simulation Sessions is limited to 30 participants, with mandatory pre-registration. Registrations will be accepted on a first-come first-served basis, depending on availability.

HIGH FIDELITY SIMULATION SESSIONS	FEE
1 Escape room: ARDS e shock settico	€ 30.00
2 Trick or treat su arresto, peri-arresto e gestione post-ROSC	€ 30.00
3 Tranquilli... ha chiamato il 118 e sta arrivando un bambino - Sessione 1	€ 30.00
4 Pre-eclampsia ed emergenze in sala parto: what else? - Sessione 1	€ 30.00
5 Quando il paziente critico è ancora più critico: technical e non technical skills in IC	€ 30.00
6 Tranquilli... ha chiamato il 118 e sta arrivando un bambino - Sessione 2	€ 30.00
7 Pre-eclampsia ed emergenze in sala parto: what else? - Sessione 2	€ 30.00

Current Italian VAT is included

## EDUCATIONAL COURSES

Admission to Educational Courses is limited to a restricted number of registrants, with mandatory pre-registration and pre-payment. Online registrations should be submitted at the websites [www.smartonweb.org](http://www.smartonweb.org) and/or [www.startpromotion.it](http://www.startpromotion.it).

**Deadline: May 10, 2023.** Registrations will be accepted on a first-come first-served basis, depending on availability.

Educational Courses do not require registration to the SMART Meeting.

CORSO TEORICO-PRATICO VAM 2023  
I FONDAMENTALI DELLA VENTILAZIONE MECCANICA

May 22-23, 2023 - Max 80 participants

Not coupled with SMART registration ..... € 580.00  
Coupled with SMART registration ..... € 460.00  
Residents ..... € 280.00

CORSO TEORICO-PRATICO  
ITACTA BEsT - CERTIFICAZIONE IN  
ECOCARDIOGRAFIA TRANSESOFOGEEA BASIC

May 22-23, 2023 - Max 30 participants

Not coupled with SMART registration ..... € 350.00  
Coupled with SMART registration ..... € 300.00  
Residents ..... € 250.00

INTERACTIVE THEORETICAL-PRACTICAL COURSE  
ACID-BASE EQUILIBRIUM: TO REMEMBER  
YOU NEED TO UNDERSTAND...

May 23, 2023 - Max 80 participants

Not coupled with SMART registration ..... € 240.00  
Coupled with SMART registration ..... € 200.00  
Residents ..... € 120.00

CORSO TEORICO-PRATICO  
EAMS - TEACH THE AIRWAY TEACHER (TAT)

May 23, 2023 - Max 16 participants ..... € 400.00

Registration includes the EAMS annual membership fee.

Registration to the TAT Course is possible ONLY at [www.airwaymanagementacademy.com](http://www.airwaymanagementacademy.com) through the link <https://www.eamshq.net/education/teach-the-airway-teacher>

CORSO  
COME TRATTARE IL PAZIENTE MALNUTRITO/CATABOLICO:  
UNA QUESTIONE MISCONOSCIUTA DI SOPRAVVIVENZA

May 24, 2023 - Max 60 participants ..... € 80.00

CORSO TEORICO-PRATICO NURSING  
UPDATE VENTILAZIONE MECCANICA PER INFERMIERI

May 25, 2023 - Max 35 participants

Not coupled with SMART registration ..... € 180.00  
Coupled with SMART registration ..... € 120.00  
ANIARTI/SIAARTI Members ..... € 140.00

Current Italian VAT is included

## GENERAL INFORMATION

### TRAVEL INFORMATION

#### BY AIR

##### Milano Linate Airport

Take bus no. 73 in the "National Arrivals Exit" area all the way to the terminal of Piazza San Babila. Then take the Metro Red Line M1 (Rho Fieramilano direction) and get off at "Amendola" stop (700 m from the meeting venue, Gate 2 entrance) or "Lotto" stop (approx. 800 m from the meeting venue, Gate 2 entrance).

##### Milano Malpensa Airport

The "MALPENSA EXPRESS" train service will take you directly from the airport to the centre of Milan in 40 minutes, stopping at the Ferrovie Nord "Cadorna" station. Take the Metro Red Line M1 (Rho Fieramilano direction) and get off at "Amendola" (700 m from the meeting venue, Gate 2 entrance) or "Lotto" stop (approx. 800 m from the meeting venue, Gate 2 entrance). Alternatively, at the Ferrovie Nord "Cadorna" station take the rail line S3/S4 and get off at "Domodossola" stop (600 m from the meeting venue, Gate 16 entrance).

##### Orio al Serio Airport

The "AUTOSTRADALE" or "AIR PULLMAN" bus service will take you directly from the airport to Milan Central Station in 60 minutes. Take the Metro Green Line M2 (Assago-Abbiategrasso direction) and get off at "Garibaldi" (one stop only). Take the Lilac Line M5 (San Siro direction) and get off at "Portello" stop (80 m from the meeting venue, Gate 2 entrance).

#### BY TRAIN

##### Central Station

Take the Metro Green Line M2 (Assago-Abbiategrasso direction) and get off at "Garibaldi" (one stop only). Take the Lilac Line M5 (San Siro direction) and get off at "Portello" stop (80 m from the meeting venue, Gate 2 entrance).

##### Garibaldi Station

Take the Metro Lilac Line M5 (San Siro direction) and get off at "Portello" stop (80 m from the meeting venue, Gate 2 entrance).

##### Cadorna Station

Take the Metro Red Line M1 (Rho Fieramilano direction) and get off at "Amendola" stop (700 m from the meeting venue, Gate 2 entrance) or "Lotto" stop (approx. 800 m from the Meeting venue, Gate 2 entrance). Alternatively, take the rail line S3/S4 and get off at "Domodossola".

#### BY CAR

From any of the ring roads circling Milan follow the signs to Fieramilanocity, or to any of the large Park & Ride car parks located close to the following Metro stops:

- Cascina Gobba (1800 cars). Green Line M2
- San Donato (1800 cars). Yellow Line M3
- Famagosta (3000 cars). Green Line M2
- Bisceglie (1900 cars). Red Line M1
- Lampugnano (2000 cars). Red Line M1

##### MiCo South Wing Parking

An underground car parking is available in the MiCo area with entrance and exit through Gate 16 - Via Gattamelata. Parking rate: € 15.00 full day, with direct payment at the cash counter. Open from h 7.30 to h 20.30, overnight parking not allowed.

### PUBLIC TRANSPORT

#### STANDARD TICKET

Fare: € 2.20. Validity: 90 minutes after stamping. Valid for one or more journeys in the entire urban ATM network including trams, buses and underground.

#### ONE-DAY TICKET

Fare: € 7.60. Validity: 24 h after stamping. Valid for unlimited journeys in the entire urban ATM network including trams, buses and underground.

#### 3-DAY TICKET

Fare: € 13. Validity: 72 h after stamping. Valid for unlimited journeys in the entire urban ATM network including trams, buses and underground.

Tickets are on sale at any authorized ATM outlet and from the ticket machines located at all underground stations.

### UNDERGROUND

The Milan Underground has five lines: Red Line M1, Green Line M2, Yellow Line M3, Blue Line M4, Lilac Line M5. To reach the meeting venue (Gate 2, Viale Eginardo entrance) by metro, follow the directions below:

#### LILAC LINE M5

Get off at "Portello" stop (80 m from the meeting venue).

#### RED LINE M1

Get off at "Amendola" stop (700 m from the meeting venue) or "Lotto" stop (approx. 800 m from the meeting venue).

#### GREEN LINE M2

Get off at "Garibaldi" stop, take the Lilac Line M5 (San Siro direction) and get off at "Portello" stop (80 m from the meeting venue).

#### YELLOW LINE M3

Get off at "Duomo" stop, take the Red Line M1 (Rho Fieramilano direction) and get off at "Amendola" stop (700 m from the meeting venue) or "Lotto" stop (approx. 800 m from the meeting venue). Alternatively, get off at "Zara" stop, take the Lilac Line M5 (San Siro direction) and get off at "Portello" stop (80 m from the meeting venue).

### SURFACE TRANSPORT

You can reach the meeting venue by surface transport as follows:

#### GATE 2, Viale Eginardo entrance:

- Bus no. 78 (Eginardo/Colleoni stop)

#### GATE 16, Via Gattamelata entrance:

- Bus no. 78 (Colleoni/Gattamelata stop)

- Tram no. 19 (Boezio stop)

- Tram no. 27 (Piazza 6 Febbraio stop)

### TAXI SERVICE

A radiotaxi service is available at the following telephone numbers: 02 8585; 02 4040; 02 7777; 02 6969

## METRO NETWORK MAP

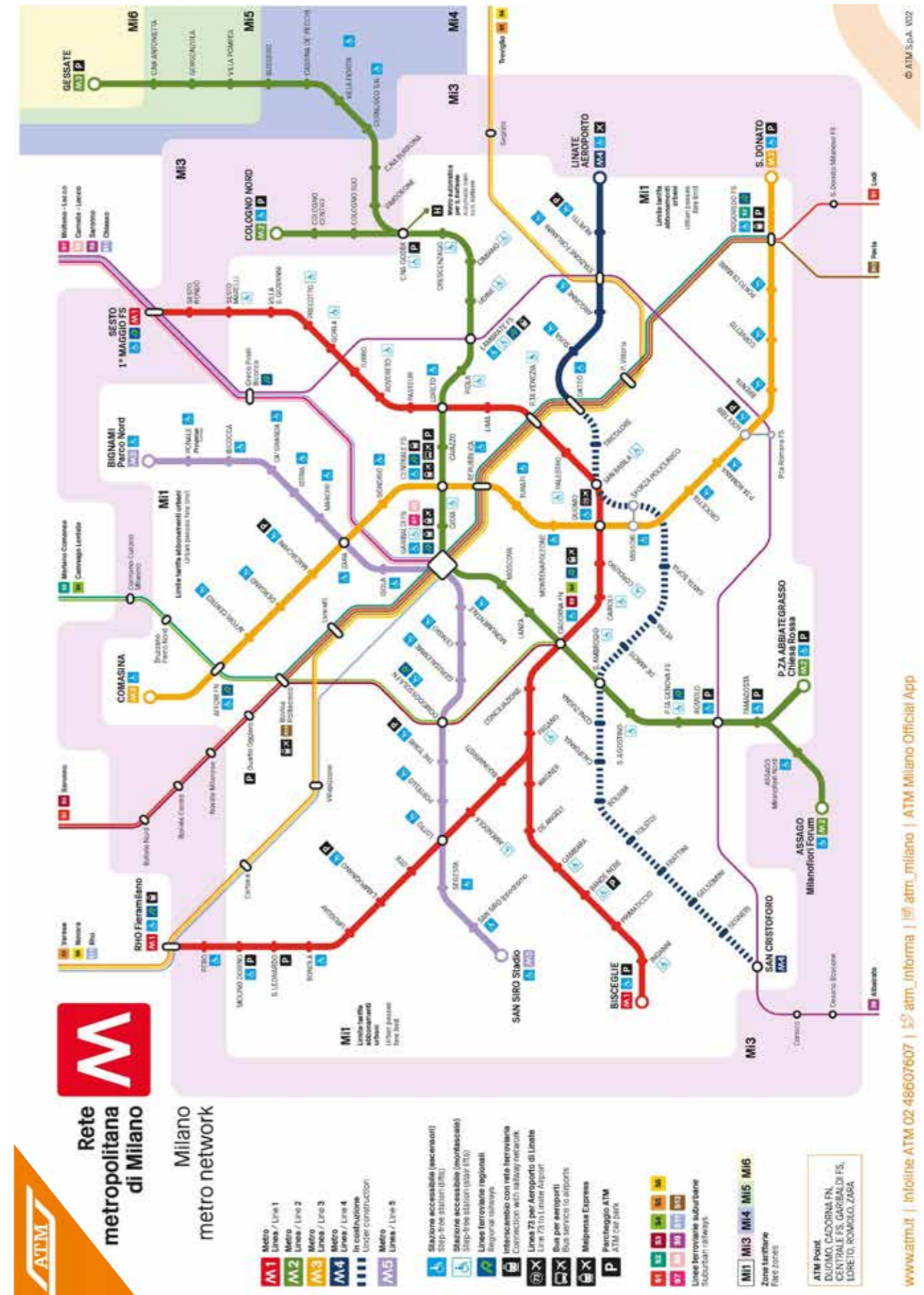

EXHIBITION

The Exhibition is open from h 8.00 of Wednesday May 24 to h 18.00 of Friday May 26.  
L'esposizione è aperta dalle ore 8.00 di Mercoledì 24 Maggio alle ore 18.00 di Venerdì 26 Maggio.

COMPANY	BOOTH No.
ACCURATE	16 - 17 - 24 - 25
AFERETICA	73 - 74
ALEA	40 - 50
ASPEN ITALIA	72
ASSITA	F5
B BRAUN	7 - 11
BD	14
BAXTER	52 - 53 - 58 - 59
BAXTER - HILL ROM	52 - 53 - 58 - 59
BIOMERIEUX	F1
BIOTEST	56 - 57
BURKE & BURKE	80
CHIESI ITALIA	42 - 43
DB MED	40 - 50
DIMAR	26 - 27 - 34 - 35
DRAEGER	62 - 63 - 66 - 67
EDIZIONI MINERVA MEDICA	T3
EDWARDS LIFESCIENCE	60
EUROSETS	32 - 33
ESTOR	22 - 23 - 30 - 31
FISHER & PAYKEL HEALTHCARE	41 - 51
FLEXICARE	T4
FRAMAR HEMOLOGIX	T2
FRESENIUS KABI	69
FRESENIUS MEDICAL CARE	69

COMPANY	BOOTH No.
GAP MED	71
GE HEALTHCARE	8
GILEAD	12
INTERSURGICAL	36 - 37 - 46 - 47
LIBRERIA CORTINA EDITORE	T6
MEDIGAS	64 - 68
MEDTRONIC	44 - 45 - 54 - 55
MINDRAY	38 - 39 - 48 - 49
MULTISALES	2 - 10
NIPPON GASES	18 - 19
NUME +	40 - 50
PIRAMAL CRITICAL CARE	T5
SEDA	77 - 78 - 79
SIAARTI	F3
SIARE	20 - 21 - 28 - 29
SIMULKARE	40 - 50
SIS. AV. MEDICALE	40 - 50
STRYKER ITALIA	F4
THERMO FISHER SCIENTIFIC	13
VEDISE HOSPITAL	15
VERATHON	75 - 76
VYAIR	61
VYGON	65
WERFEN	T1

LAYOUT 1 - EXHIBITION

LEVEL 2

EXHIBITION AREA

- > Exhibition
- > Reception
  - Pre-registered Physicians & Nurses
  - New registrations Physicians & Nurses
  - Faculty
  - Sponsoring Companies
  - Info Point
- > E-Poster Corner 1
- > E-Poster Corner 2
- > WeSmart Space 1
- > WeSmart Space 2
- > Meet the Expert Point
- > Simulation Center 2
- > Smart Social Lounge
- > Catering Areas
- > Bar



ACKNOWLEDGEMENTS

We are grateful to the following Companies for their contribution to the success of the SMART Meeting.  
 Si ringraziano le Aziende per il contributo dato alla realizzazione dello SMART.



LAYOUT 2 - MAIN ENTRANCE

LEVEL 1

MAIN ENTRANCE

- > **Reception**
  - Pre-registered Residents & Students
  - New registrations Residents & Students
  - Pre-registered Visitors
  - New registrations Visitors
- > **Cloakroom**

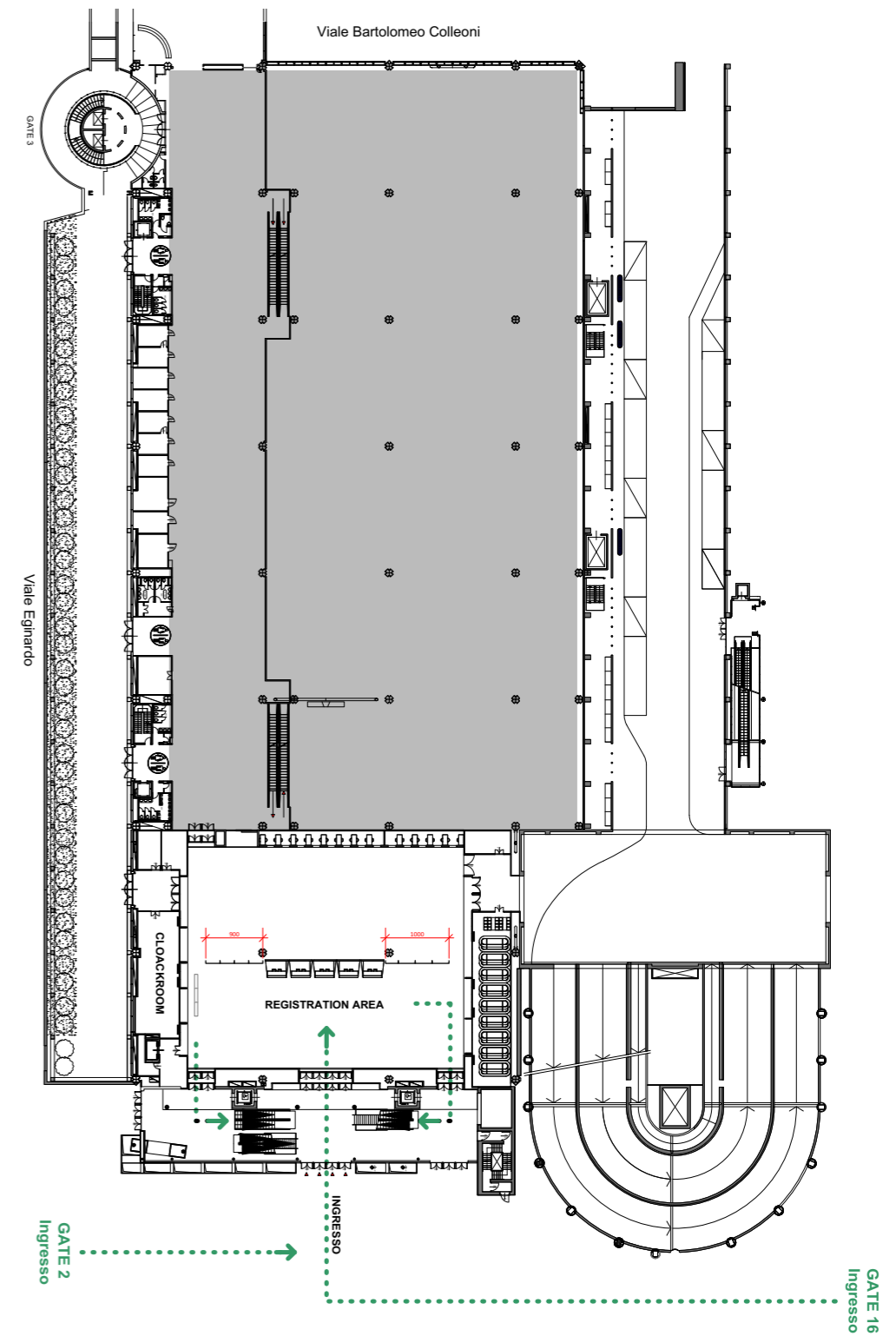

LAYOUT 3 - SCIENTIFIC AREA

TOTAL LAYOUT

LEVEL 2

LEVEL 2

SCIENTIFIC AREA

- Halls
  - Amber 1-2
  - Amber 3-4
  - Amber 5-6
  - Amber 7
  - Amber 8
  - Brown 1
  - Brown 2
- Suite 3
- Suite 4
- Stairs to Mezzanine Level
- Simulation Center 1
- Faculty Lounge
- Slide Center
- Cafeteria
- Tower Lounge Buffet Service

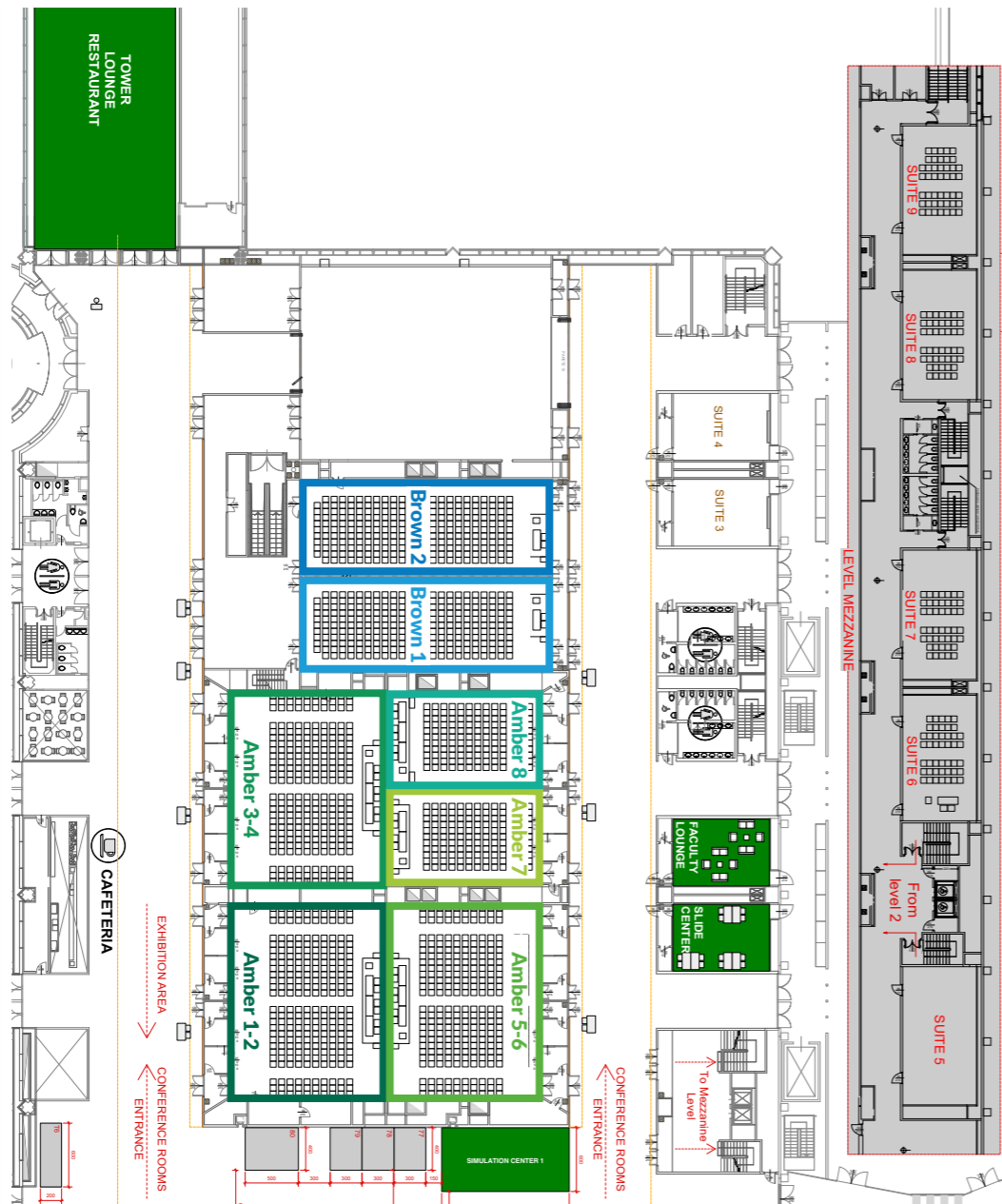

TOTAL LAYOUT

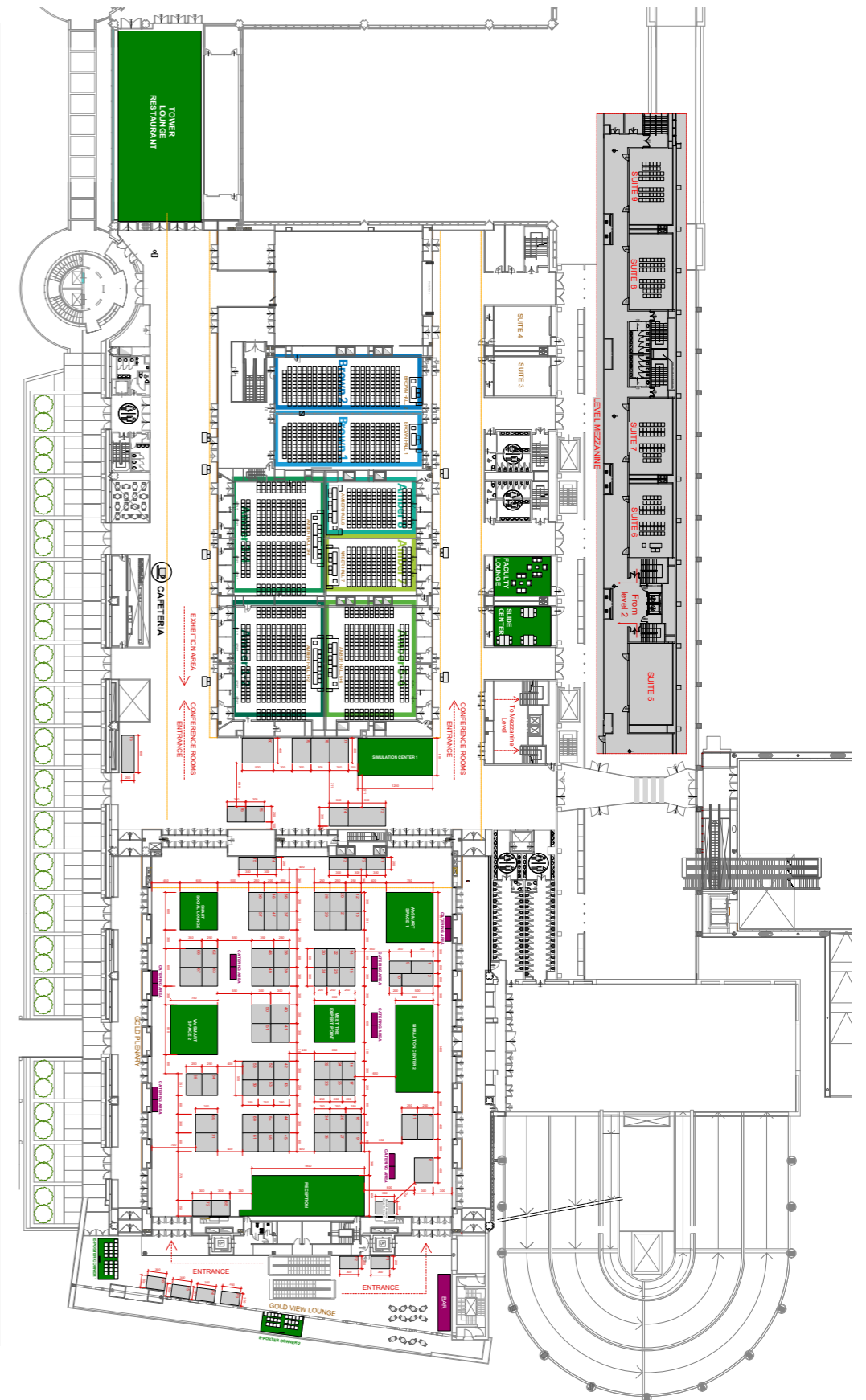

MAP OF THE AREA

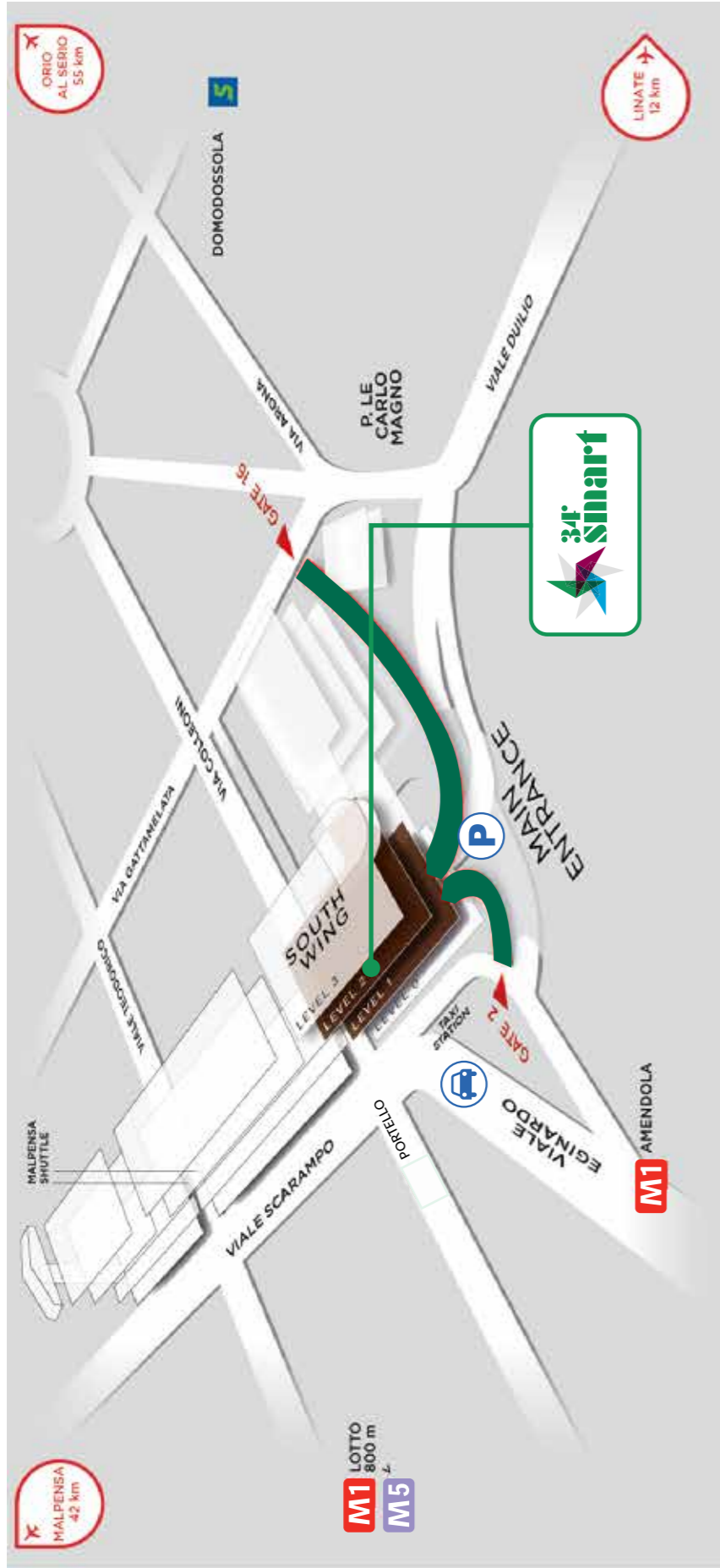

Underground  
Metropolitana



Underground  
Metropolitana



TRENORD Suburban Rail Line S3/S4  
TRENORD Linea Ferroviaria Suburbana S3/S4



Taxi



MiCo South Wing PARKING - Entrance/Exit through Gate 16 Via Gattamelata  
Parking rate: Euro 15.00 full day, direct payment at the cash counter.  
Open from h 7.30 to h 20.30, overnight parking not allowed.

PARCHEGGIO INTERRATO MiCo SUD - Ingresso/Uscita dal Gate 16 Via Gattamelata  
Tariffa: Euro 15,00 per l'intera giornata, pagamento diretto in cassa con addetto.  
Aperto dalle 7.30 alle 20.30. Non sono concesse soste notturne.

See you at



35 smart

Smart Meeting Anesthesia  
Resuscitation InTensive care

MILAN | May 29-31, 2024



Smart Meeting Anesthesia  
Resuscitation inTensive care

[www.smartonweb.org](http://www.smartonweb.org)

Follow us on:   